



ACRYLIC CLAWFOOT BATHTUB SERIES

OWNER'S MANUAL & INSTALLATION GUIDE



READ ENTIRE INSTALLATION GUIDE PRIOR TO INSTALLING THE BATHTUB

This bathtub should only be installed by a certified plumber
two people are required to lift the bathtub

For installation and assembly videos, please visit our website
www.streamlinebath.com

OR

our YouTube page by searching for
"Streamline Bath"

OR

following the below link to our channel:

<https://www.youtube.com/channel/UCII7TGMbkwoGSqzo-pGfaJw>



**External Drain
Assembly Video**



**Clawfoot Assembly
Video Version 1**



**Clawfoot Assembly
Video Version 2**



**ND-0245-XX Drain
Assembly Video**

PRIOR TO INSTALLATION

These products must be installed by a fully insured and licensed plumber only.

Installation of any product by anyone other than fully insured and licensed plumber shall void limited warranty.

We are not responsible for any local code compliance for this product.

Building and plumbing codes may vary state-to-state.

Streamline shall not be held liable for any and all incidental damages or flood caused due to use of this product.

Streamline shall not be held liable for any and all fees stemming from cost of installation, re-installation, removal, subsequent damage, or transportation in a case of a product defect.

TOOLS REQUIRED



SILICONE



MEASURING
TAPE



PENCIL

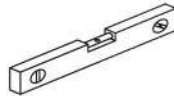

LEVER BAR



ADJUSTABLE
KEY



SAFETY
GLASSES

WHAT'S IN THE BOX

** XX REPRESENTS DIFFERENT COLORS OF THE ITEM

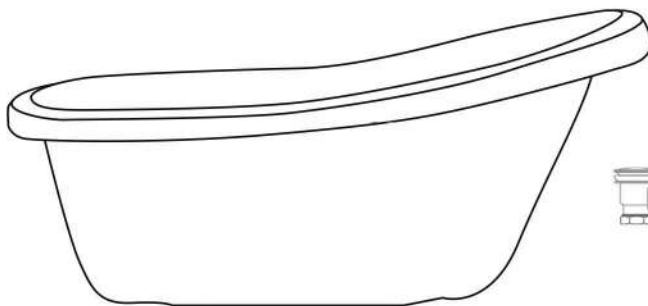

BATHTUB

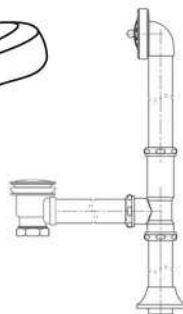

DRAIN MODEL: N-DWF-XX OR ND-045-XX**

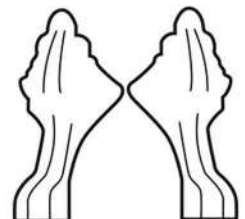

CLAW FEET

DRAIN MODEL COMPATIBILITY

CLAWFOOT BATHTUB

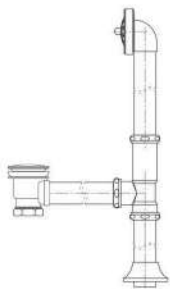

MODEL: N-DWF-XX**



N-100-60CFWH-DM
N-103-68CFBL-DM
N-104-60CFYW-DM
N-105-60CFGR-DM
N-106-60CFAMZ-DM
N-107-60CFBLU-DM



N-340-67CFWH-FM
N-341-59CFWH-FM
N-342-63CFWH-FM
N-343-55CFWH-FM



N-350-63CFYW-FM
N-351-63CFGR-FM
N-352-63CFAMZ-FM
N-353-63CFMBL-FM
N-354-55CFYW-FM



N-355-55CFGR-FM
N-356-55CFAMZ-FM
N-357-55CFMBL-FM
N-368-63CFBLU-FM
N-369-55CFBLU-FM



N-344-59CFBL-FM
N-345-67CFBL-FM



N-1120-59CFBL-DM
N-1121-67CFWH-DM



N-861-68CFWH-FM



N-900-60CFWH-DM
N-901-68CFWH-DM



N-920-60CFWH-FM

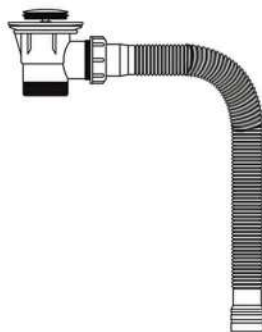

MODEL: ND-045-XX**



N-480-61FSHW-FM



N-1020-62CFWH-FM
N-1021-62CFRD-FM



N-1080-59CFWH-FM
N-1081-67CFWH-FM



N-1100-59CFWH-FM



N-481-61FSBL-FM
N-482-61FSRD-FM
N-483-61FSYW-FM
N-484-61FSGR-FM
N-485-61FSAMZ-FM
N-486-61FSBLU-FM



N-346-55CFWHIN-FM
N-347-59CFWHIN-FM
N-348-63CFWHIN-FM
N-349-67CFWHIN-FM
N-358-55CFYWIN-FM
N-359-55CFGRIN-FM



N-360-55CFAMZIN-FM
N-361-55CFMBLIN-FM
N-362-59CFMBLIN-FM
N-363-63CFYWIN-FM
N-364-63CFGRIN-FM
N-365-63CFAMZIN-FM



N-366-63CFMBLIN-FM
N-367-67CFMBLIN-FM
N-370-55CFBLU-FM
N-371-63CFBLU-FM

**XX REPRESENTS DIFFERENT COLORS OF THE ITEM

WHAT'S INCLUDED IN THE CLAWFOOT BOX

Applicable models:

N-CFL1775-XX
 N-CFL11603-XX
 N-CFLK36572-XX
 N-CFL46572-XX
 N-CFL1912-XX * Comes with 3 metal plates

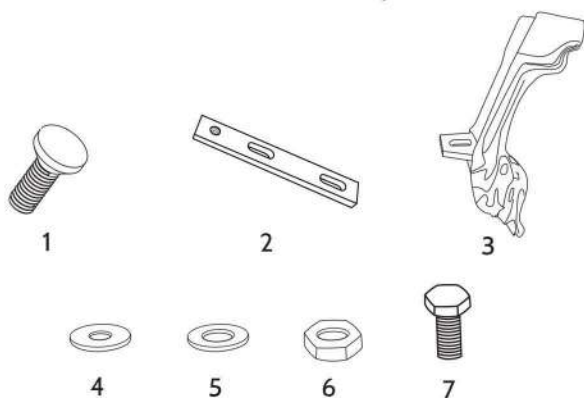

No.	ITEM	Qty
1	Leveling Feet	4
2	Metal Plate	4
3	Claw Feet	4
4	Washer With Small Diameter	8
5	Washer With Large Diameter	4
6	Nut	12
7	Hex Bolt	4

Applicable model:

N-CFL11601-XX

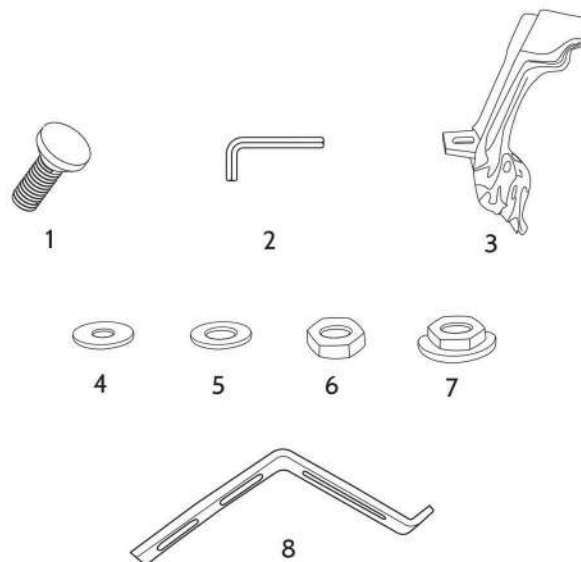

No.	ITEM	Qty
1	Leveling Feet	4
2	Hex Key	1
3	Claw Feet	4
4	Washer With Small Diameter	8
5	Washer With Large Diameter	8
6	Nut	12
7	Nut With Washer	16
8	Metal Plate	4

**XX REPRESENTS DIFFERENT COLORS OF THE ITEM

DRAIN DIAGRAMS

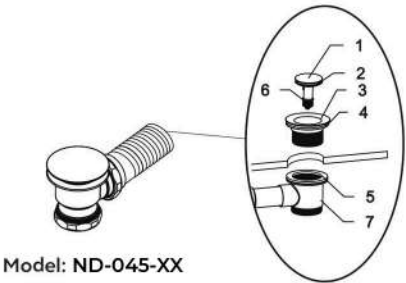

No.	ITEM	Qty
1	Pop-Up Cover	1
2	O Ring	1
3	Strainer	1
4	Upper Rubber Gasket	1
5	Lower Rubber Gasket	1
6	Cartridge	1
7	Drain Tree	1

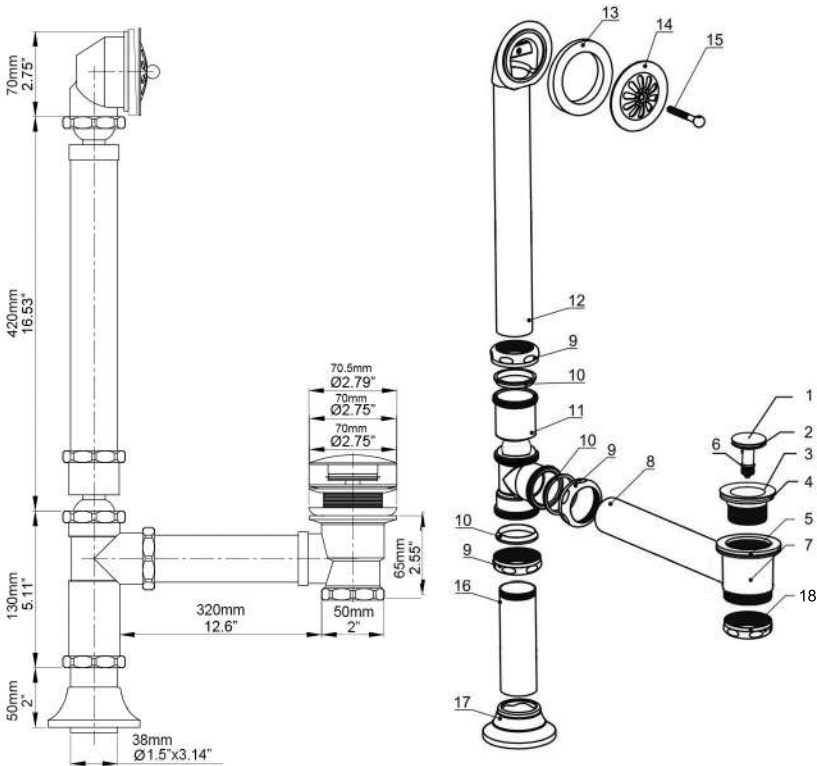
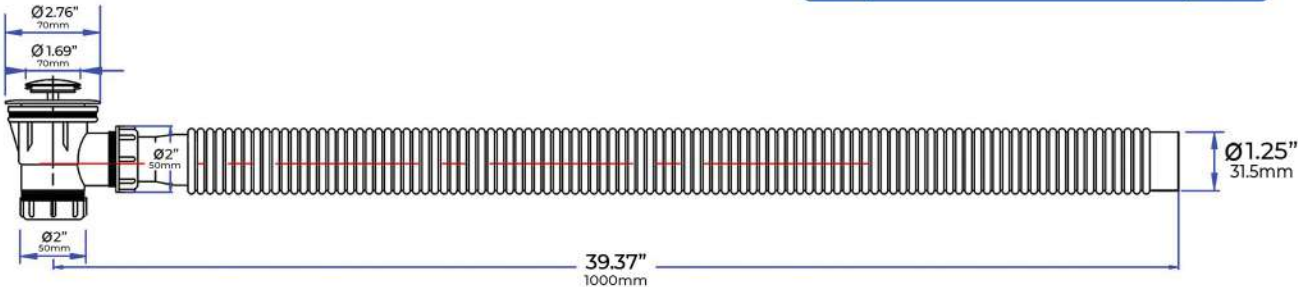

No.	ITEM	Qty
1	Pop-Up Cover	1
2	O Ring	1
3	Strainer	1
4	Upper Rubber Gasket	1
5	Lower Rubber Gasket	1
6	Cartridge	1
7	Drain Tee	1
8	Drain Ell	1
9	Coupling Nut	3
10	Washer	3
11	Tee	1
12	Overflow Ell	1
13	Tapered Rubber Gasket	1
14	Overflow Plate	1
15	Pin Bolt	1
16	Tail Piece	1
17	Flange	1
18	Drain Cap	1

Model: N-DWF-XX

**XX REPRESENTS DIFFERENT COLORS OF THE ITEM

CLAWFOOT DIAGRAM

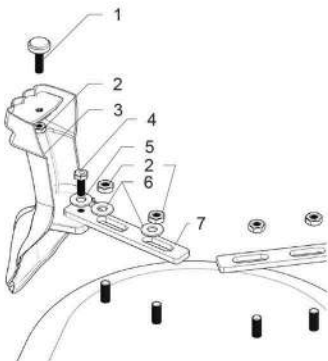
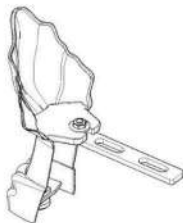

No.	ITEM	Qty
1	Leveling Foot	1
2	Nut	3
3	Clawfoot	1
4	Hex Bolt	1
5	Washer With Large Diameter	1
6	Washer With Small Diameter	2
7	Metal Plate	1

Applicable models:
 N-CFL1775-XX
 N-CFL11603-XX
 N-CFLK36572-XX
 N-CFL46572-XX
 N-CFL1912-XX * Comes with 3 metal plates

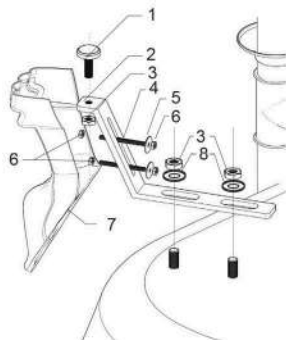
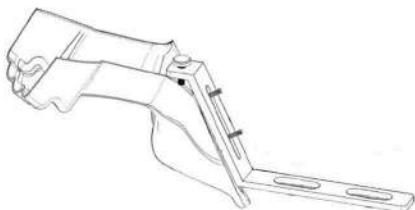

No.	ITEM	Qty
1	Leveling Foot	1
2	Metal Plate	1
3	Nut	3
4	Bolt	2
5	Washer With Small Diameter	2
6	Nut With Washer	4
7	Clawfoot	1
8	Washer With Large Diameter	2

Applicable model:
 N-CFL11601-XX

**XX REPRESENTS DIFFERENT COLORS OF THE ITEM

BATHTUB INSTALLATION

- 1** Ensure that the floor at the installation site has sufficient floor support and level.

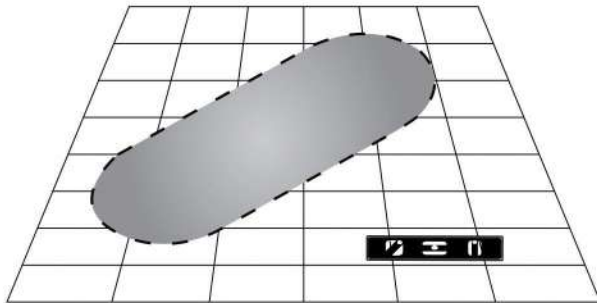

- 2** Waterproofing the floor is highly recommended.

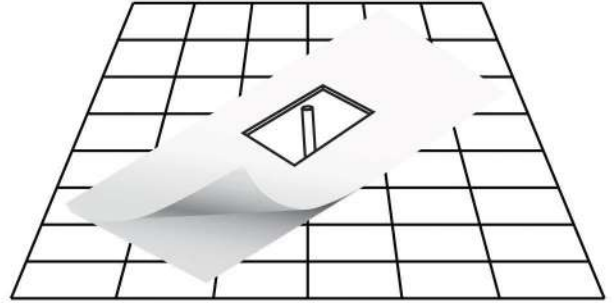

- 3** Determine the location of the drainpipe on the floor by taking measurement of the drain and waste location underneath the unit. Clean the drain hole area in preparation of setting the drain. The area should be dry & free from any debris.

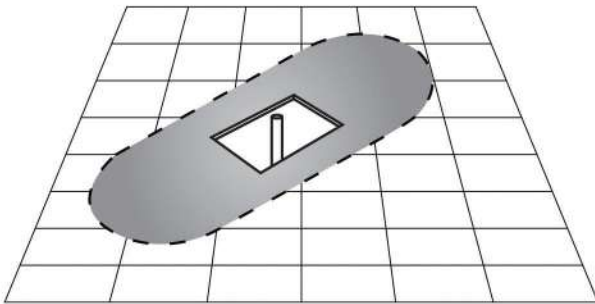

- 4** Remove the bathtub from its box. It is recommended that the bathtub is carried by a minimum of two people. Ensure to carry and set down the bathtub only in the upside-down position.

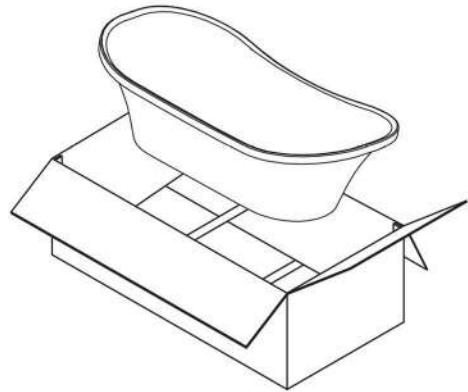

- 5** Gently place the bathtub in the upside-down position on a tarp or cardboard sheet in order to avoid contact with any surface.

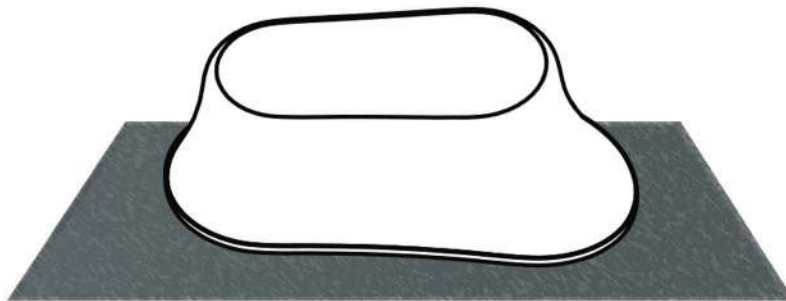

BATHTUB INSTALLATION

- 6** This step will be attaching the clawfeet to the bathtub. Please check the previous page to see which clawfoot model is applicable to your bathtub.

Applicable models :

N-CFL1775-XX
N-CFL11603-XX
N-CFLK36572-XX
N-CFL46572-XX
N-CFL1912-XX *

* Comes with 3 metal plates



1. Take 1 adjustable leveling foot (Part #1) and place it through the hole at the top of the clawfoot (Part #3). Secure the leveling foot by using 1 nut (Part #2) on the underside of the bolt for the leveling foot. Screw and tighten the nut.

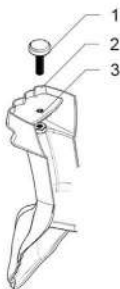

2. Remove the safety caps from the bolts on the bathtub.

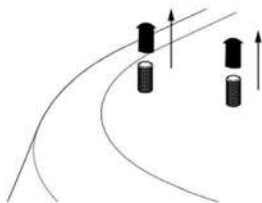

3. Take 1 metal plate (Part #7) and place it on top of the bathtub bolts, making sure that the end of the plate with the singular hole is facing outwards on the bathtub.

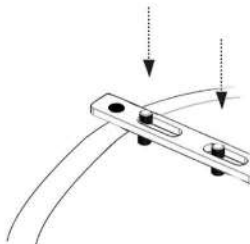

Applicable models:

N-CFL11601-XX

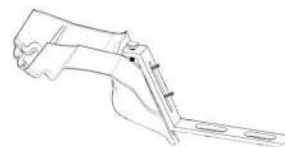

1. Remove the safety caps from the bolts on the bathtub.

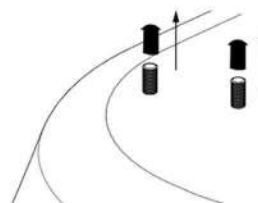

2. Take 1 adjustable leveling foot (Part #1) and place it through the hole at the top of the metal plate (Part #2). Secure the leveling foot by using 1 nut (Part #3) on the underside of the bolt for the leveling foot.



3. Take 1 bolt (Part #4) and 1 nut with washer (Part #6) and screw the nut onto the bolt, approximately $\frac{1}{4}$ of the length of the bolt. Repeat this step for the second bolt.



**XX REPRESENTS DIFFERENT COLORS OF THE ITEM

BATHTUB INSTALLATION

4. Take 2 washers (Part #6) and place 1 washer over each bathtub bolt.

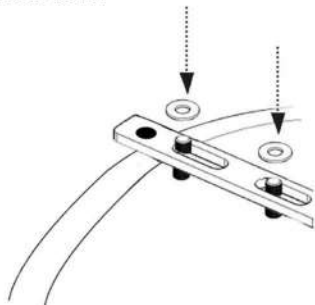

5. Take 2 nuts (Part #2) and place 1 over each bathtub bolt. Tighten, but do NOT tighten fully. This is so the metal bar can be adjusted and slid to accommodate.

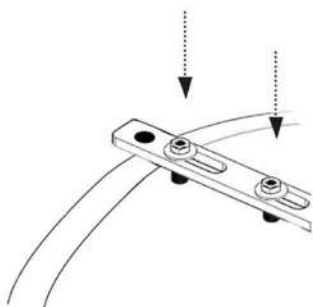

6. Take 1 hex bolt (Part #4) and take 1 washer with a large diameter (Part #5) and put the washer through the bolt. Here is how it should look in your hand:

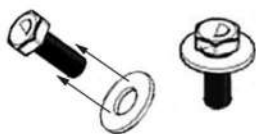

7. Screw the nut with the washer on top of the metal bar but do not screw in fully. Leave room to insert the clawfoot.

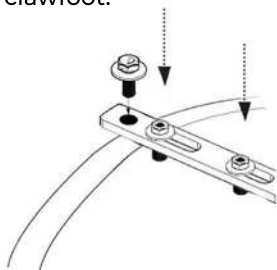

4. Take the bolt, nut and screw them into the clawfoot as shown in the diagram below. Make sure to tighten the bolt into the clawfoot using the provided hex key.

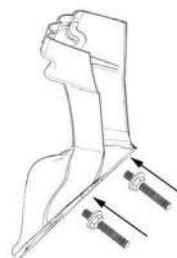

5. Place the metal plate (Part#2) over the bolts on the bathtub as shown in the diagram below. Make sure to adjust the metal plate so that it fits snug with the bolts on the bathtub. This will help to ensure that the clawfeet are placed correctly and are functioning properly.

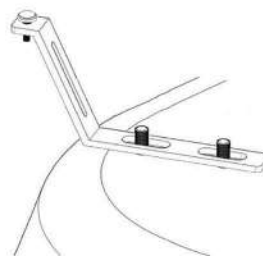

6. Take 1 washer (Part #8) and put it over the bolt on the bathtub. Then take 1 nut (Part #3) and place it over the washer, but do not tighten the bolt completely. Repeat this step for the other bolt on the bathtub.

