

## Getting Started:

Identify the location of the bracket for install with the type of substructure you're fastening into and consider its application use prior to install as it can be used to support an overall 36" length for overhang support, countertop support, vanity support or counter island leg support.

### Included Fasteners:

1/4" x 1" Flat Head Machine Screws, 1/4" Hex Lock Nut,  
 1/4"x 2.5" Hex Lag screws , 1/4" Adjustable feet and  
 1/4" Flat Washers

\*This installation document should not be considered a specific recommendation for your particular application. Federal Brace cannot provide installation guidelines that meet the particulars of every application. This document should be considered a "help sheet" that provides considerations about the general characteristics of a particular type of support and installation.

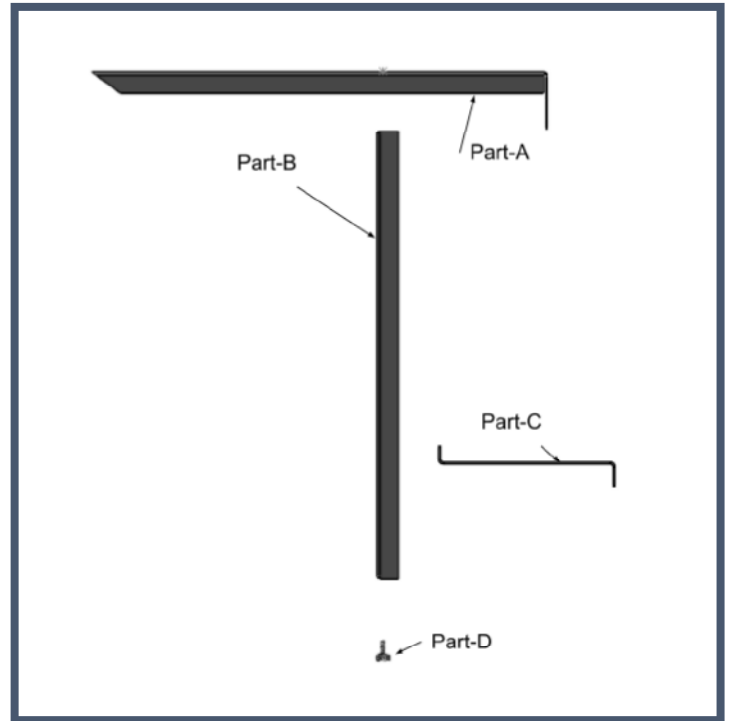

## Tools Needed:

Measuring Tape, Stud Finder, Drill Driver, Silicone or adhesive for countertop surface mounting, Pencil or Painter's Tape  
 Bubble Level

Note: 1/4" x 2-1/2" Concrete Hex Lag screws are not included for brick/masonry wall applications

## Installation Steps:

**Step 1:** Find the parts required for installation.

NOTE: Do not space more than 24" between brackets.

**Step 2:** Determine the height from floor to the countertop surface and follow ADA guidelines for installing (where applicable).

**Step 3:** Assemble part-A and part -B using the 1/4" x 1" machine screw, washers and 1/4" hex lock nut provided in place. Fasten the leveling feet provided through the threaded hole on part B (bottom flange).

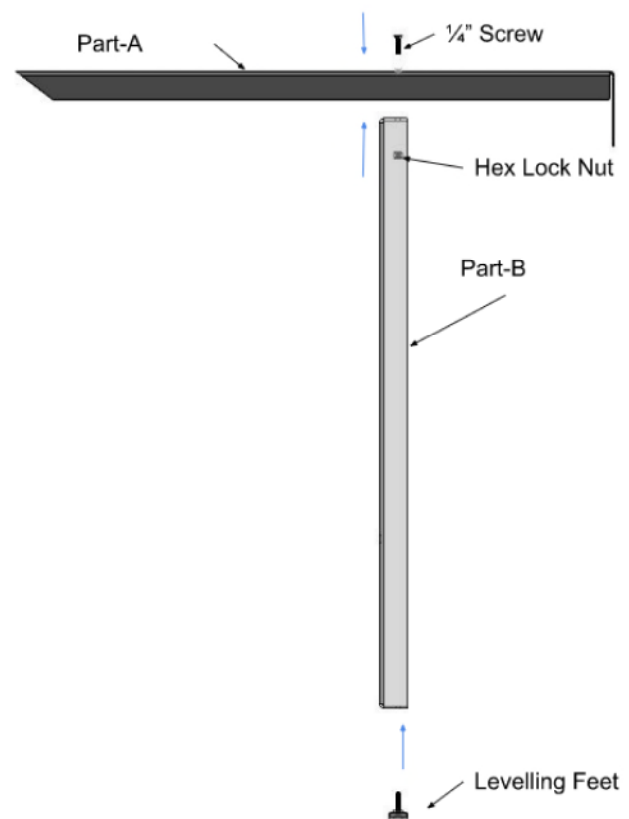

## Installation Steps (cont.):

**Step 4:** Adjust the height of the bracket with the leveling feet and install the assembled parts to the structure using ¼" Lag screws provided.

**Step 5:** Assemble part-C to part-B by the ¼" machine screw, washers and nut provided.

**Step 6:** Attach the stabilizer bracket (Part-C) to the wall/substructure by making sure the support bracket is level. Hold the bracket against the wall at stud location, ensuring that the center of the bracket is at the center of stud.

**Step 7:** Repeating steps 1-6 for consecutive brackets without spacing longer than 24" for maximum weight capacity.

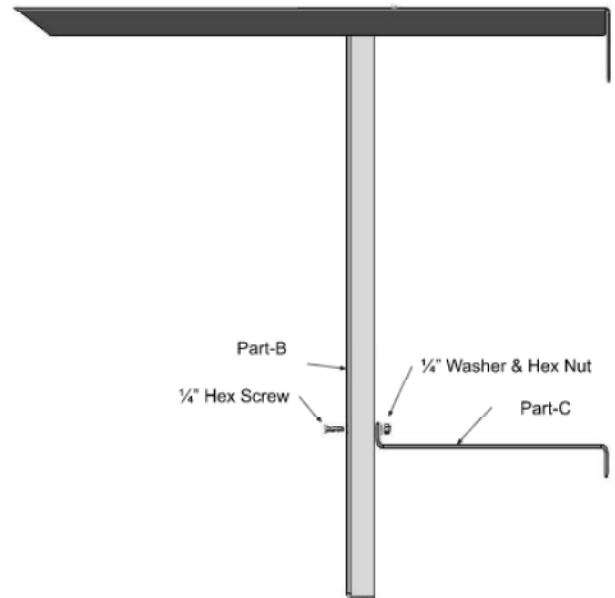

## ADA Compliance

To meet ADA compliant guidelines, counters shouldn't be mounted higher than 34 inches from the floor, and they should have a knee clearance of 27 inches high, 30 inches wide, and 11 to 25 inches deep. You also need clear floor space and insulated pipes under a sink.

When mounted at the appropriate height, The Braila ADA Countertop Support Bracket will provide the 27" knee clearance and be ADA compliant.

This still would apply when creating a fascia wall in front of the support leg (where applicable).

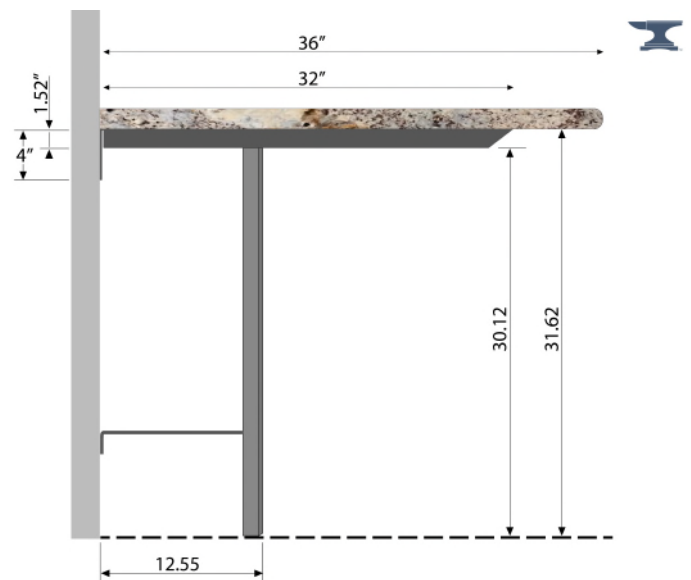

**BRAILA**  
 ADA COUNTERTOP SUPPORT BRACKET

**∴kitchensource.com**  
 1.800.667.8721



PROUDLY  
 AMERICAN  
 MADE