

# Lazy Susan Installation Instructions

## TOOLS REQUIRED:

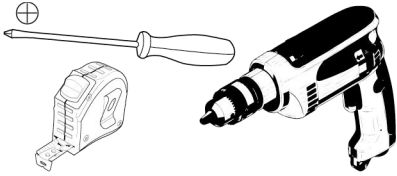

## ESTIMATED ASSEMBLY TIME:

# 25 MIN

## CARE AND MAINTENANCE:

Clean with a damp cloth and wipe parts dry.

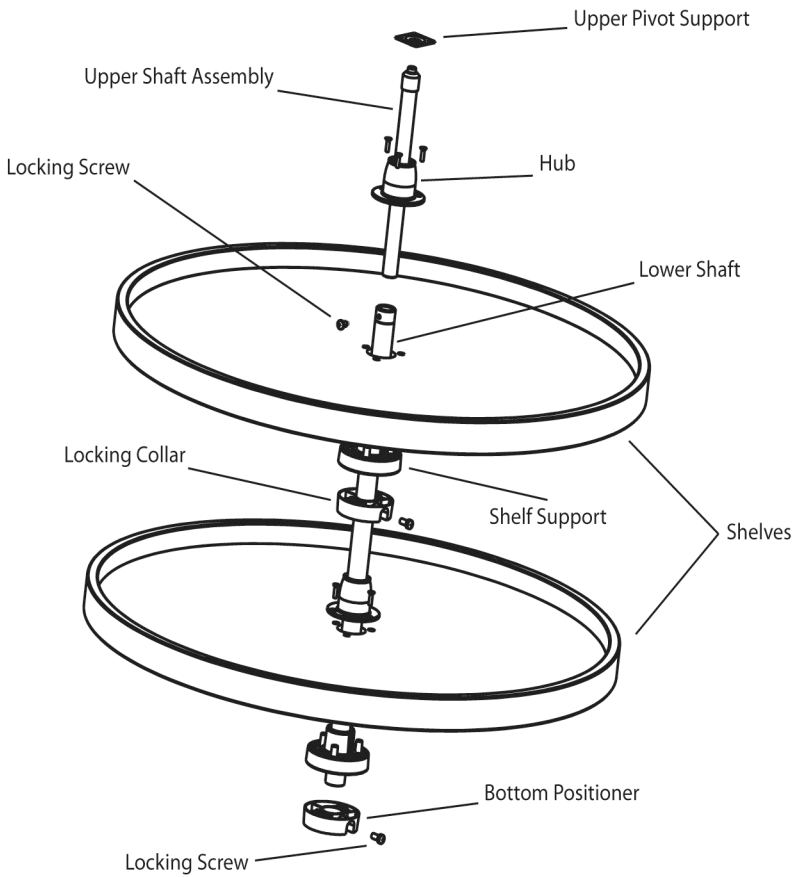

- 1) Attach shelf support and hub to lazy susan shelf by using (3)  $\frac{3}{4}$ " x #8 flat head screws. Repeat steps for other shelf(s)
- 2) Install bottom positioner hardware to center of cabinet floor. Check to make sure that your shelves will have no interference with the interior of the cabinet or door.
- 3) Install upper pivot support to center of cabinet ceiling using (4)  $\frac{3}{4}$ " x 8 screws
- 4) Insert upper shaft assembly into lower shaft.
- 5) Place both trays inside of the cabinet with the locking collar in-between the shelves. Once inside the cabinet, insert the shaft into the shelves and into the bottom positioner hardware. Finally tighten locking screw on bottom positioner hardware.
- 6) Slide upper shaft into upper pivot support and tighten locking screw to secure in place.
- 7) Determine the space required for your upper shelf(s) and lock the collar in place by tightening.