

Quartztone®
Undermount Single Bowl
Model G-100U



G-100U

FEATURES

- 80% quartz
- 8-11/16" depth
- Intrinsically hygienic Non-porous surface
- Natural, antibacterial hygiene protection system
- Silky to the touch, 3 times harder than natural granite
- Food-safe, UV-stable-will not fade
- Heat resistance to +500°F
- Highest resistance to thermal shock, scratches and chips
- Color-fast throughout
- Fits 30" sink base • cUPC listed
- Supplied with cutout template, fasteners and instructions
- Lifetime Limited Warranty

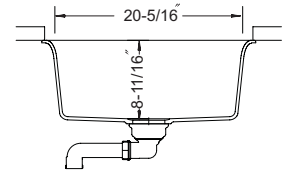
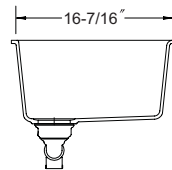
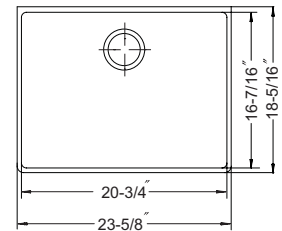

OPTIONAL COLORS



Midnite Metallic **Mocha** Solid **Earth** Structured **Sand** Solid **Cloud** Solid

| OVERALL DIMENSIONS | EACH BOWL | CUTOUT SIZE | PACKAGING* | WEIGHT* |
|--------------------|--------------------|--------------|------------|------------|
| 23-5/8" x 18-5/16" | 20-3/4" x 16-7/16" | See Template | 1/10 pcs. | 33/370lbs. |

*Standard packaging: Single boxed /Pallet of single boxed.
All dimensions are in inches. Specifications subject to change without notice.

OPTIONAL ACCESSORIES

- Bottom Grid: 629704
- Cutting Board : CB-4100
- Wire Tray: WT-3500
- Strainer Options: Stainless steel strainers, Color strainers, Color Disposal flanges

Project/Job name _____

Architect/Engineer _____

Contractor _____

Model _____ Q'ty _____

Notes _____