

STAINLESS STEEL
MAPLE TOP CHEF TABLES



Model Above Shown with Rear Bar

Item #: _____ Qty #: _____
 Model #: _____
 Project #: _____

Rolled Rim Edge on Front & Square Side Edges



Under Shelf Model Shown

FEATURES & CONSTRUCTION:

Hard Wood Top.

Gussets welded to support channels.

Rear Bar Models have front to back leg braces bolted to legs and requires assembly. Rear bar is welded to legs.

Center Bar Models have front to back Leg braces welded to legs. Center bar bolts to legs and requires assembly.

Under Shelf Models have aluminum die cast "leg-to-shelf" clamp to secure shelf to leg eliminating unsightly nuts & bolts.

Shelf can be adjusted to desired height.

MATERIAL:

TOP: Laminated 2" Thick HARD MAPLE.

SHELF: 18 gauge stainless steel.

LEGS: 1 5/8" diameter tubular stainless steel.

Stainless steel gussets.

1" adjustable stainless steel bullet feet.



Under Shelf Models Feature "THE PROVEN" ORIGINAL ADVANCE TABCO Adjustable Underself with Die Cast Leg Clamp



Cross & Rear Bar Models Feature 1-5/8" Leg Brace to Ensure Stability

Under Shelf Models

L	24" Wide		30" Wide	
	Model	Model	Model	Model
48"	SN-ISW1937	SN-ISW1940		
60"	SN-ISW1938	SN-ISW1941		
72"	SN-ISW1939	SN-ISW1942		

Rear Bar Models

L	24" Wide		30" Wide	
	Model	Model	Model	Model
48"	SN-ISW1943RB	SN-ISW1946RB		
60"	SN-ISW1944RB	SN-ISW1947RB		
72"	SN-ISW1945RB	SN-ISW1948RB		

CENTER BAR MODELS AVAILABLE!



SN-ISW1961
Stainless Steel Casters

Accessories

Model	Description
SN-ISW1961	Set of Four - 5" Stainless Steel Commercial Casters (2 with Brakes) 20" x 20" x 5" Stainless Steel Drawer (Table will Include Drawer Brackets. Drawer Installation Required)
SN-ISW1962	

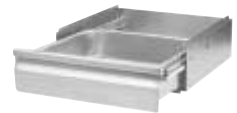

SN-ISW1962
Stainless Steel Drawer

Stainless Craft at

DIMENSIONS and SPECIFICATIONS

ALL DIMENSIONS ARE TYPICAL TOL ± .500"

All Units Shipped Unassembled (KD) for Reduced Shipping Costs.

UNDER SHELF MODELS

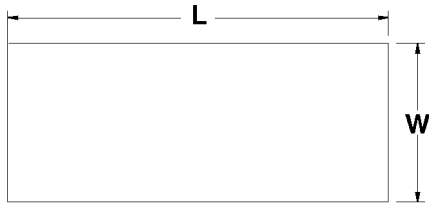

Rolled Rim Edge on Front & Square Side Edges

L	24" Wide	Wt.	30" Wide	Wt.
48"	SN-ISW1937	100 lbs.	SN-ISW1940	120 lbs.
60"	SN-ISW1938	125 lbs.	SN-ISW1941	150 lbs.
72"	SN-ISW1939	150 lbs.	SN-ISW1942	180 lbs.

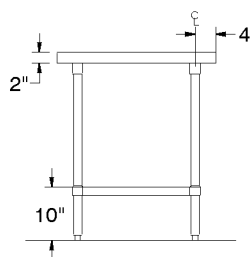
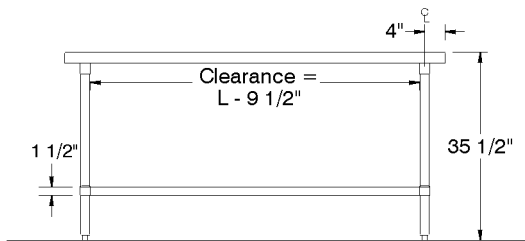

REAR BAR MODELS

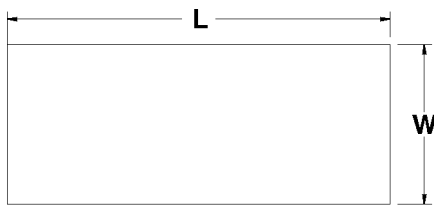

L	24" Wide	Wt.	30" Wide	Wt.
48"	SN-ISW1943RB	80 lbs.	SN-ISW1946RB	96 lbs.
60"	SN-ISW1944RB	100 lbs.	SN-ISW1947RB	120 lbs.
72"	SN-ISW1945RB	120 lbs.	SN-ISW1948RB	144 lbs.

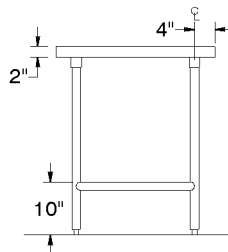
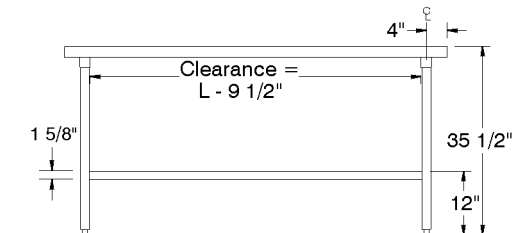

CENTER BAR MODELS AVAILABLE!

Stainless Craft at