

Kräus[®]

INSTALLATION MANUAL

All-in-One Filtration Set

FS-1000

Congratulations on the purchase of your new Kraus® plumbing fixture!

Please keep the box and packaging materials until your product is completely installed. If you have any questions, require technical assistance or have any problems with your product:



DO NOT RETURN TO STORE

**Please contact our Customer Service Team
1-800-775-0703 / customerservice@kraususa.com**


Have the model number available and retain a copy of your receipt with purchase date for reference.


If for any reason this product does not meet your expectations, please be sure to repack this product in the original box and packaging material to avoid damage during transit.

Installation and use must comply with all state and local laws, regulations and codes.

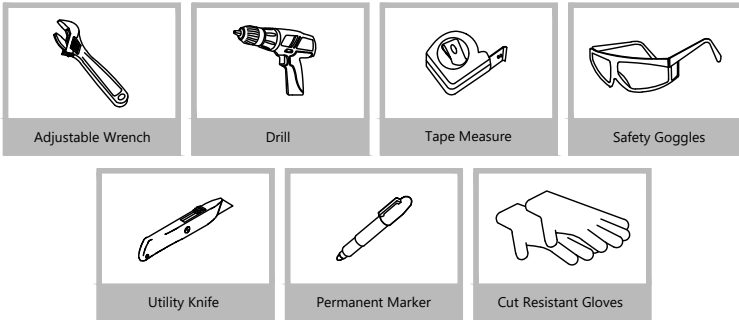


Prior to Installation:

- Make sure you have all necessary parts by checking the diagram and parts list. If any part is missing or damaged, please contact Kraus Customer Service at 800-775-0703 for a replacement.
- Read all instructions and safety warnings and ensure you have all tools, parts, and equipment necessary for a safe installation.
- Observe all state and local plumbing and building codes.
-  **CAUTION** - Make sure to only install this filtration system to the cold water supply. To reduce the risk of personal injury, do not install the system to the hot water supply.
- **IMPORTANT** - Replace the filter cartridges every 6 months or when the 700 gallon capacity has been exceeded, whichever comes first. You may also need to replace if you notice a decrease in water flow. The failure to follow this instruction may affect product performance and void the warranty.
- **IMPORTANT** - Flush the system for 10 minutes prior to first use and 5 minutes after prolonged periods of nonuse. The failure to follow this instruction may affect product performance and void the warranty.
- **NOTE:** Make sure to mark the installation date on the filter head and cartridges for your reference.

 **CAUTION** - To avoid the risk of personal injury, the system is to be supplied only with cold water.

Tools Required



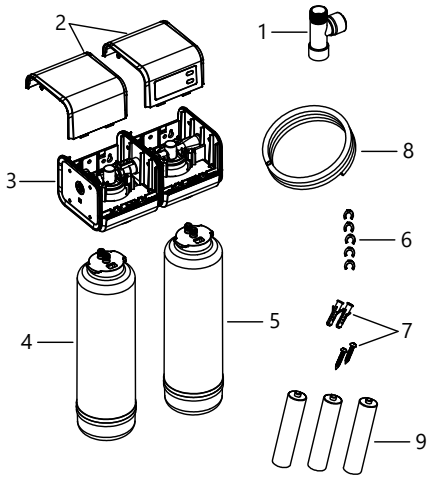
Care & Maintenance

* To keep the product clean & shining, follow the steps below:

1. Rinse with clean water & dry with a soft cloth.
2. Do not clean with soaps, acid, polish, abrasives or harsh cleaners as use of such products may affect product performance or void the warranty.
3. Do not use cloth with a coarse surface.
4. Unscrew the aerator and rinse clean when necessary.

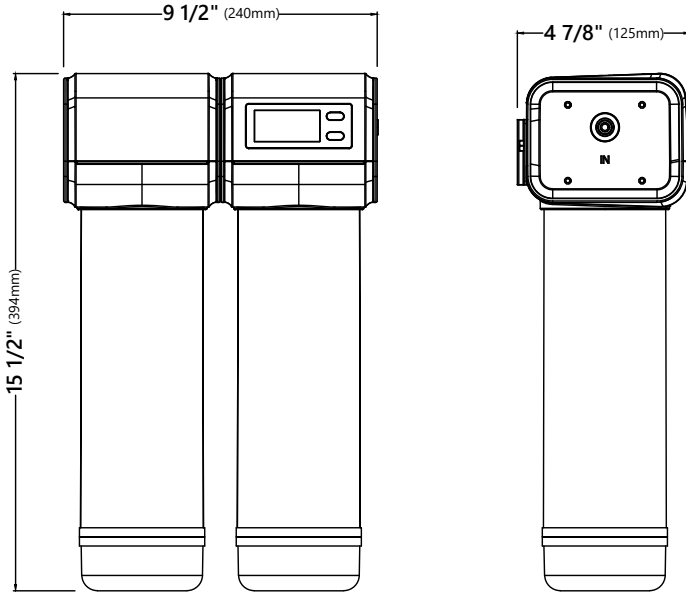


Diagram and Parts List



1. Tee Adapter
2. Covers
3. Manifold
4. Polypropylene Cartridge
5. Compressed Carbon Cartridge
6. Quick Connect Lock Tab
7. Mounting Screw & Anchor x 2
8. Tubing 1/4" x 8'
9. 3x AAA Batteries

Dimensions and Specifications



Flow Rate 0.7GPM

Capacity: 700 gallons

NOTE: Depending on local water quality and use environment, the actual filtered water flow rate and total filtered water volume will vary.

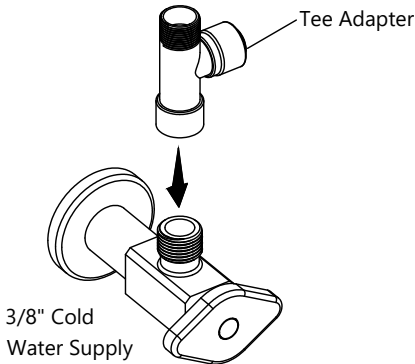
Min static pressure: 40 psi (275.8 kPa)

Max static pressure: 120 psi (827.4 kPa)

Inlet Water Temperature 41° - 100° F

⚠ CAUTION - Do not use with water that is micro biologically unsafe or of unknown quality without adequate disinfection before or after the system.

Step 1.

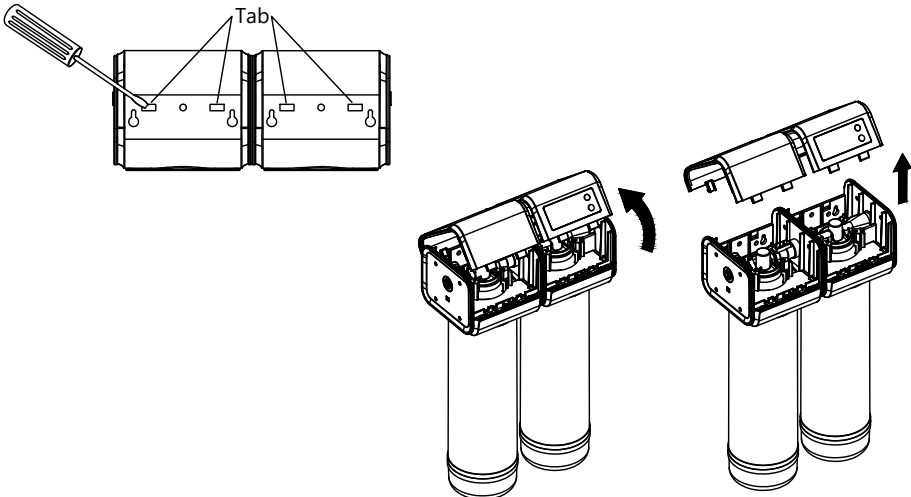


Turn off the cold water supply and turn on the faucet to relieve the water pressure and drain water from the water line. Disconnect the cold water supply line from the cold water supply valve. Install the tee adapter to the cold water supply valve.

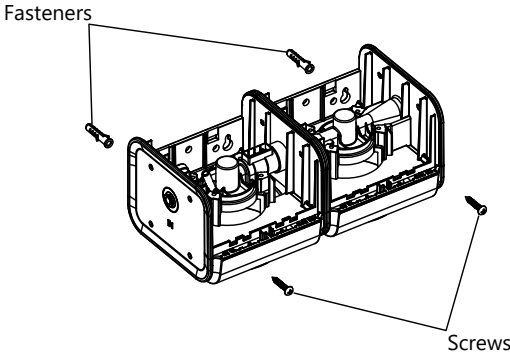
NOTE: Make sure to check for washer in the Tee Adapter before connecting to the angle stop.

Step 2.

Using a flathead screwdriver push the 4 tabs in on the back of the manifold to remove the covers. Once pushed in, lift up and the covers will slide off.



Step 3.

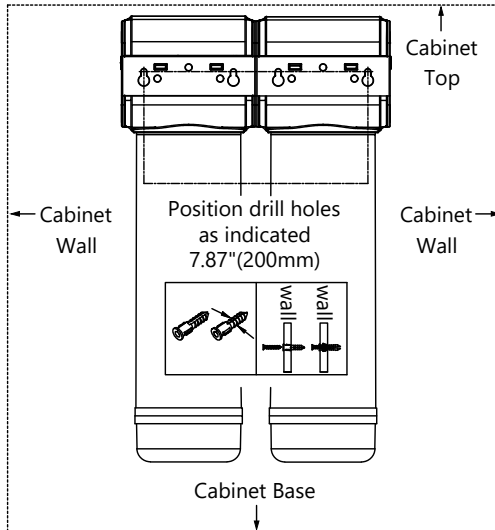


Using the mounting template, mount the filter head. Align the mounting holes of the filter head at the proper mounting location. Mark the hole locations with a permanent marker. Place the filter head aside and pre-drill the mounting holes, if necessary, depending on the fasteners selected. Partially thread the fasteners into the cabinet wall and slide the filter head over the fasteners. Secure the filter head by tightening the fasteners.

CAUTION - To avoid the risk of personal injury, wear safety glasses and cut resistant gloves with non-slip grip when drilling.



NOTE: This system is designed for vertical installation. Make sure that the bottom of the filter cartridge will be at least 2" from the bottom of the cabinet.



MOUNTING TEMPLATE

Step 4.

Install the batteries into the back of the cover behind the LCD screen. Remove the battery cover. Place batteries inside and slide the cover back on. Each time the batteries die when you're using your filtration system you will need to remove the system from the cabinet wall to replace.

