

# Kräus<sup>®</sup>

## INSTALLATION GUIDE

### Urbix<sup>™</sup> Industrial Stand Alone Filtration Faucet

FF-101

### Prior to Installation:

- Make sure you have all necessary parts by checking the diagram and parts list. If any part is missing or damaged, please contact Customer Service
- Turn off the hot and cold water supply at the angle stops and turn on the old faucet to release any built up pressure. Remove existing faucet. Clean sink or countertop to remove any debris, plumber's putty, or silicone.
- Flush angle stops to release any debris prior to installation.
- Pre-drilled hole size requirement: 1 1/4" (min)
- Max countertop thickness: 3 1/16

### Tools Required

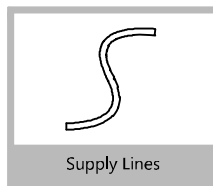
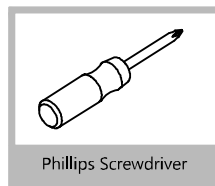
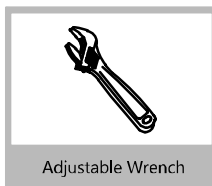

## Diagram and Parts List

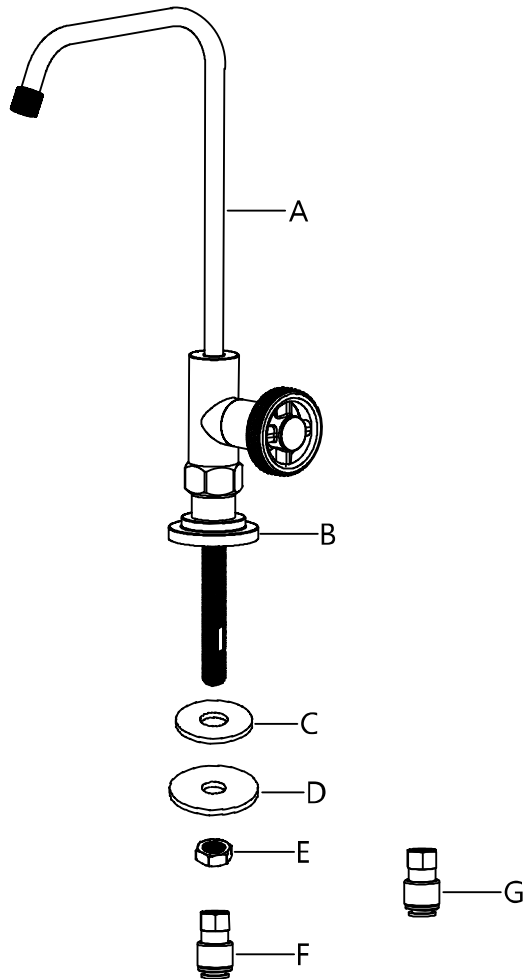

- A. Faucet Assembly
- B. Flange
- C. Rubber Washer
- D. Metal Washer
- E. Mounting Nut
- F. Connector 3/8"
- G. Connector 1/4"

## Faucet Dimensions

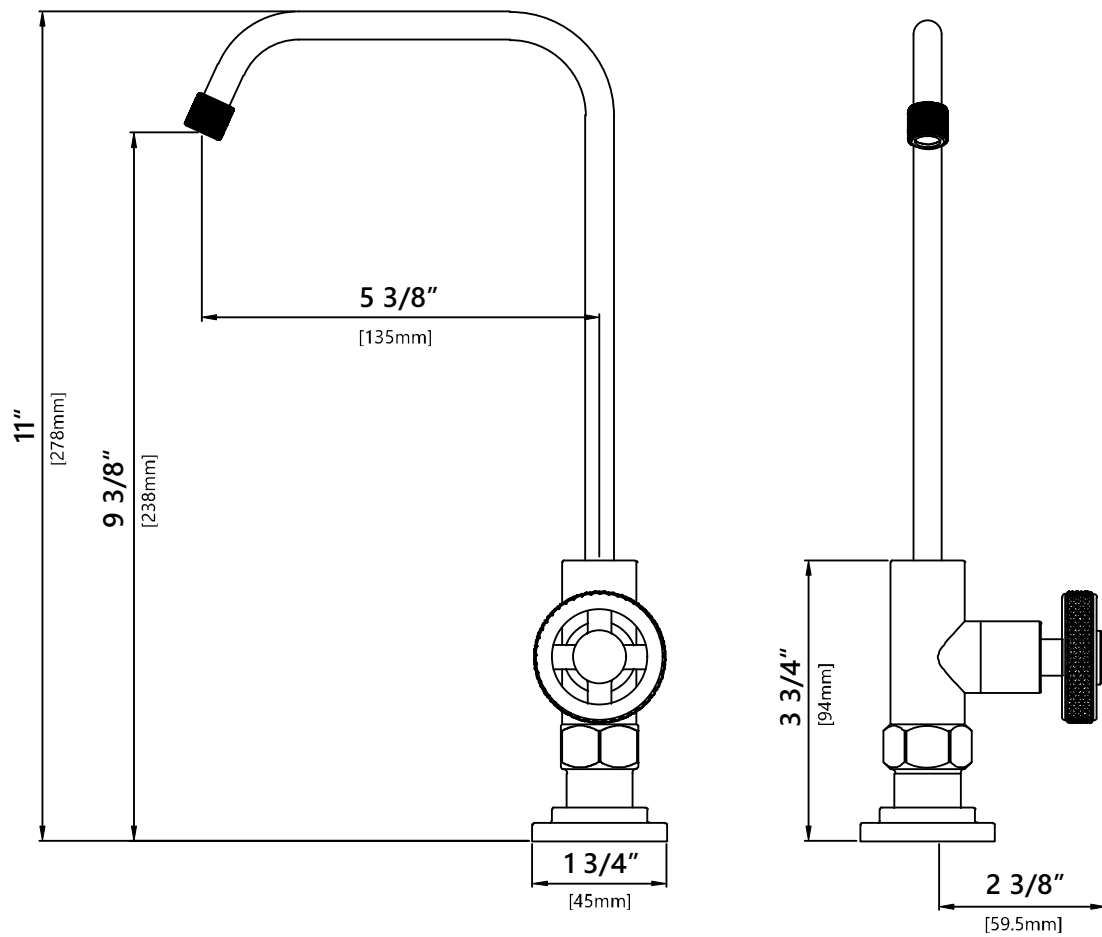

### Installer Tip:

Shut off main water supply before installing new faucet.

## Step 1: Preparing for installation

---

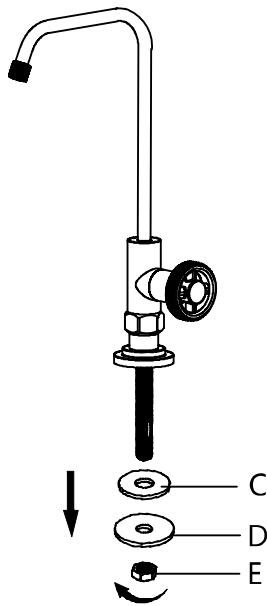

Remove the rubber washer (C), metal washer (D), and mounting nut (E) from the end of the stud.

## Step 2: Installing the faucet assembly

---

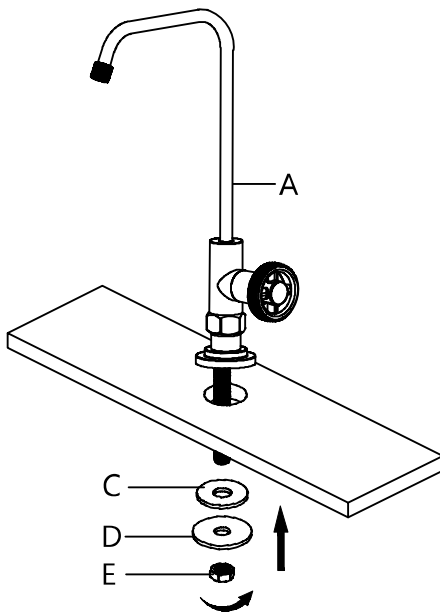

Place the faucet assembly (A) through the selected hole in the sink or countertop. On the underside of the sink or countertop, slide the rubber washer (C) and metal washer (D) onto the stud. Thread the mounting nut (E) onto the stud, and tighten securely using your wrench.