

## USE58 Series Undermount Slide Installation Instructions

### IMPORTANT:

Before you begin, make sure you familiarize yourself with all the parts and fully read the instructions.

### CUSTOMER SERVICE:

Toll-free customer help line available weekdays between 7:00am and 6:00pm Central Time at 800-463-0660.

### TOOLS NECESSARY:

Screw gun and drill bits. NOTE: If screw gun has a clutch, set to lowest setting so as not to over tighten and/or strip screws during installation.

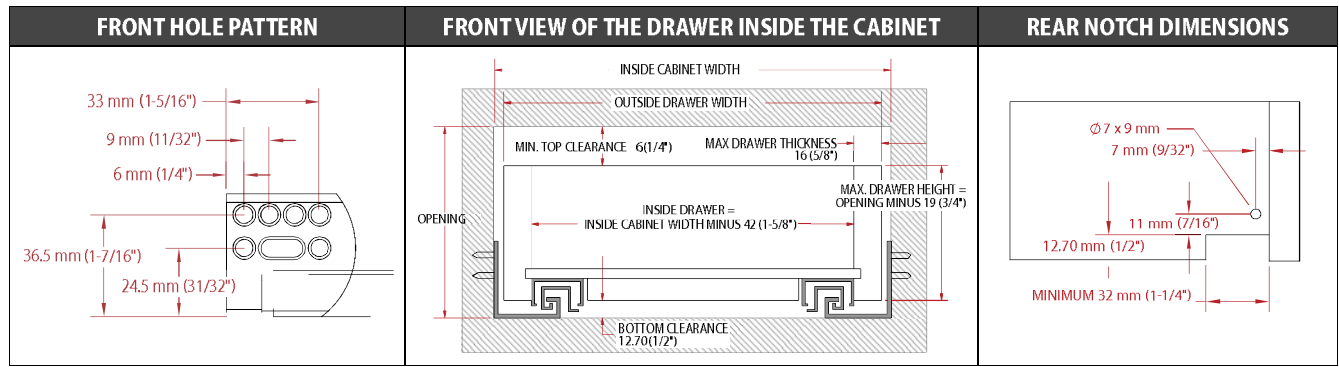

### USE58-100 AND USE58-300 SERIES DRAWER BOX MINIMUM WIDTH (VARIES BY CLIP)

	US-CLIP-6WZ	US-CLIP-6W	US-CLIP-4WZ	US-CLIP-4W	US-CLIP-2W	US-CLIP-NR
<b>5/8" (16 mm) material</b>	7.25"	7.25"	7.25"	7.25"	6.25"	4.75"
<b>1/2" (13 mm) material</b>	7"	7"	7"	7"	6"	4.5"

### USE58-500 SERIES MINIMUM WIDTH (VARIES BY CLIP)

<b>5/8" (16 mm) material</b>	8.25"
<b>1/2" (13 mm) material</b>	8"

INSIDE CABINET DEPTH



INSIDE CABINET WIDTH

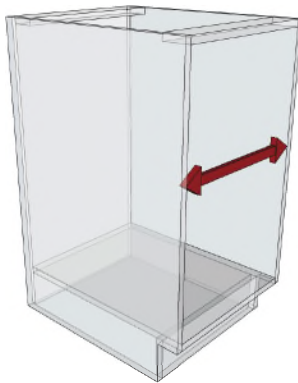

DRAWER DEPTH

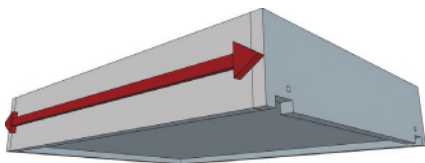

DRAWER WIDTH

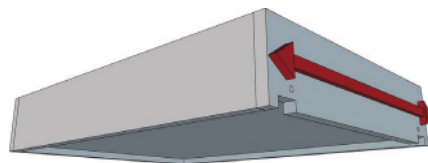

DRAWER HEIGHT

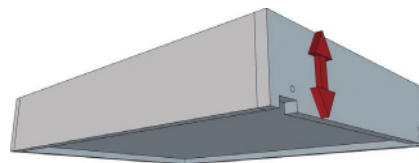

MAXIMUM DRAWER HEIGHT =  
OPENING MINUS 19MM (3/4")

OUTSIDE DRAWER WIDTH CALCULATIONS

Drawer Side Thickness	Inside Cabinet Width Deduction
<b>5/8" (16 mm)</b>	<b>3/8" (10 mm)</b>
19/32" (15 mm)	15/32" (12 mm)
9/16" (14 mm)	9/16" (14 mm)
<b>1/2" (13 mm)</b>	<b>5/8" (16 mm)</b>
15/32" (12 mm)	23/32" (18 mm)

### Verify drawer box is correct width

- Determine Drawer Side Thickness
- Drawer box width = Inside Cabinet Width minus proper Inside Cabinet Width Deduction (**See chart below**)
  - For 5/8" drawer box material, subtract 3/8" from inside cabinet width.
  - For 1/2" drawer box material, subtract 5/8" from inside cabinet width.
- Example: A drawer box made of 5/8" material would measure 14-5/8" for an inside cabinet width of 15".

### Verify drawer front is square

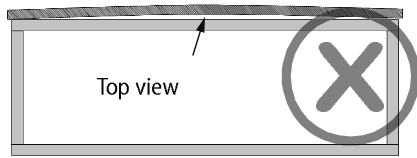
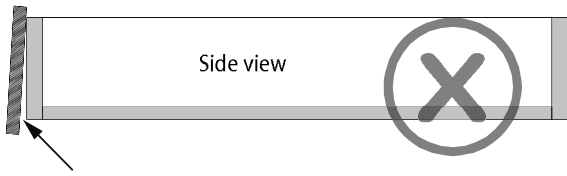

### Install slide release clips

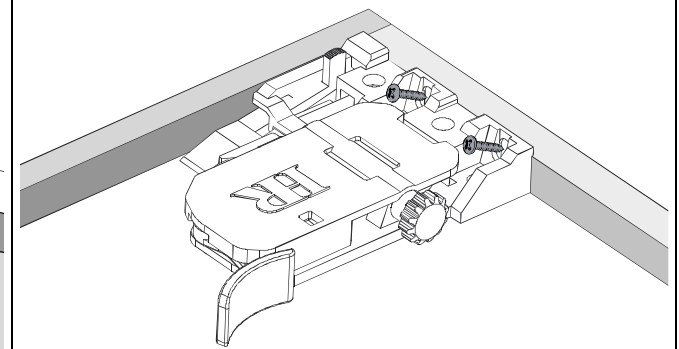
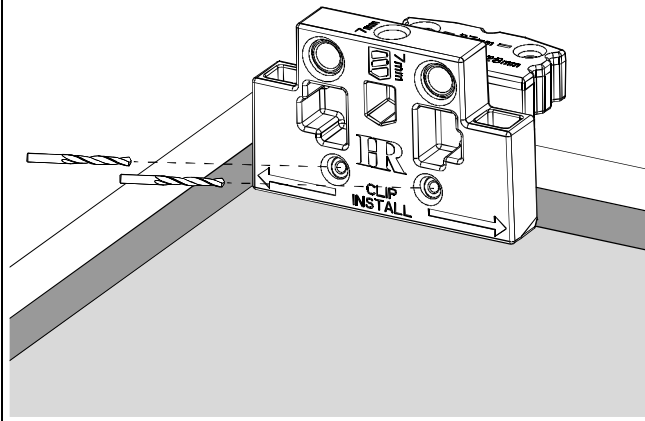

Turn drawer box upside down and drill holes for undermount slide release clips. Shown with optional multi-tool (HR-TOOL-300)

Install slide release clips with recommended # 6 x 5/8" pan head screws.

### Measure and mark for slide placement

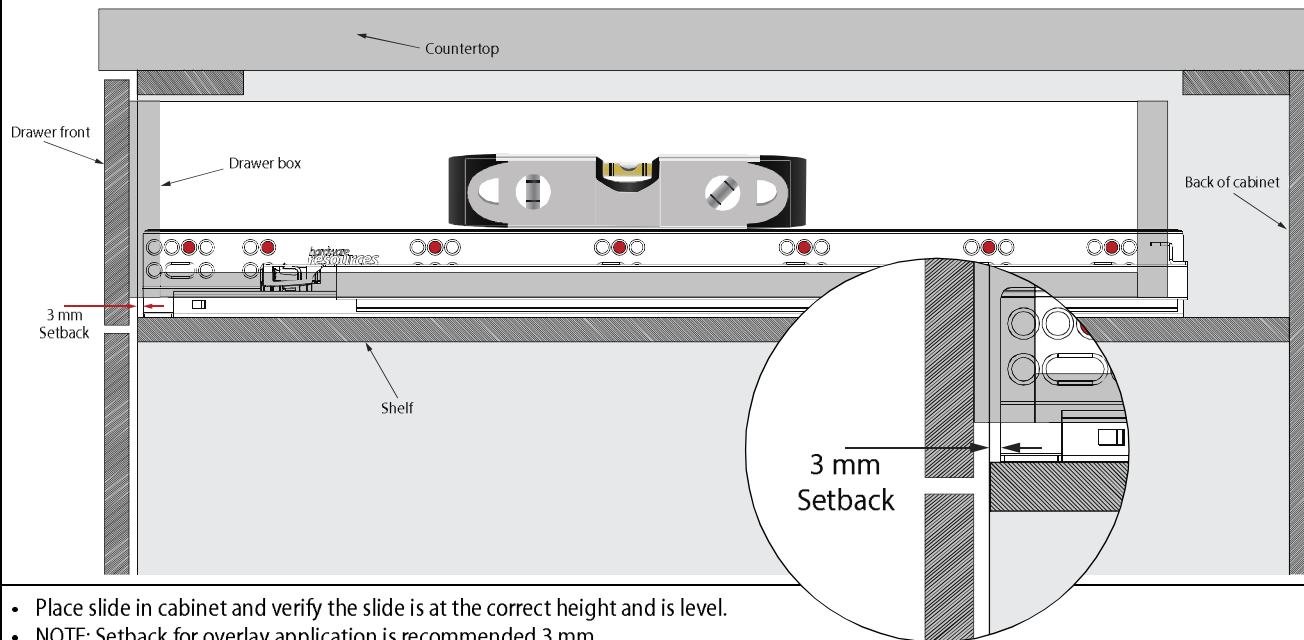

- Place slide in cabinet and verify the slide is at the correct height and is level.
- NOTE: Setback for overlay application is recommended 3 mm.
- Mark holes for predrilling. Remove slide while drilling holes to prevent wood chips from getting on the slide.
- Install slides with recommended #6 x 5/8" pan head screws.

\* Not compatible with drawer bumpers

### Insert and lock drawer box

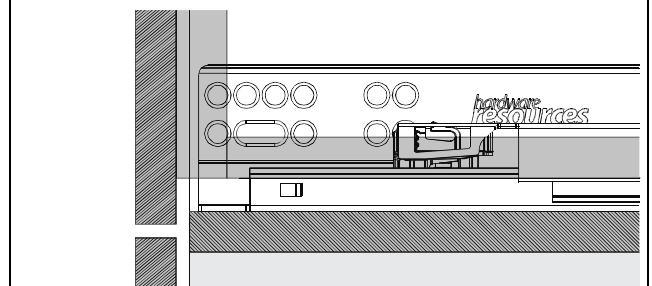
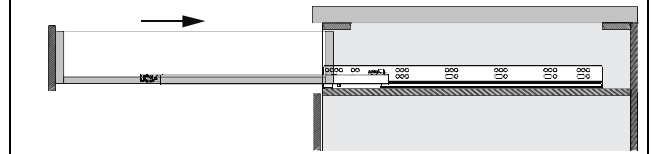
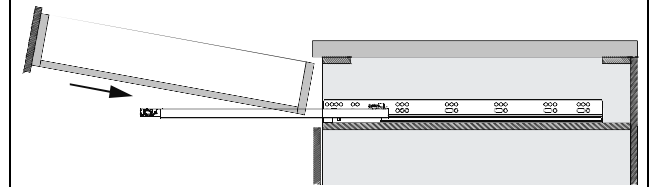

- Insert the drawer box until release clips lock in.