

Swing-up Fittings

Duo

- Two applications; lid or flap stay
- Can be mounted left or right
- Adjustable braking effect
- Lid/Flap stay clip mounts to brackets without tools
- Use of a magnet is recommended when used as a flap stay application, refer to page 143
- For aluminum doors refer to page 352



Wood Door Lid Stay



Aluminum Door Lid Stay



Flap Stay Doors

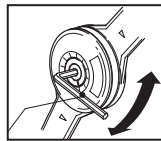
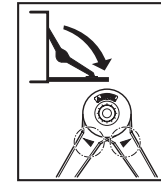
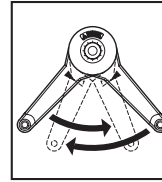
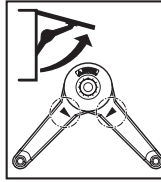
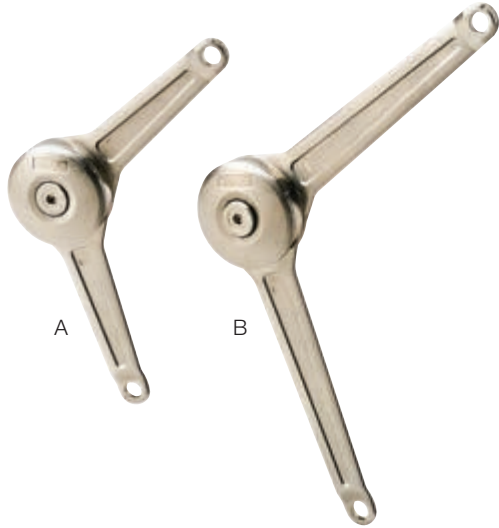

Function:
Set the function to stopping or braking by adjusting the screw with a 4 mm Hex Key. (sold separately - see next page)

Duo Lid/Flap Stay Arm

Material: zinc alloy

Version	Finish/Color	Item No.
A (6 kg/13 lbs.)	nickel-plated	373.66.500
B (8 kg/18 lbs.)	nickel-plated	373.66.700
A (6 kg/13 lbs.)	silver	373.66.800
B (8 kg/18 lbs.)	silver	373.66.900
A (6 kg/13 lbs.)	black	373.66.200
B (8 kg/18 lbs.)	black	373.66.300

*Packing: 20 pcs.

Please order mounting brackets separately (below)

Cabinet Mounting Bracket

- For attachment to side panel of cabinet

Material: steel

Mounting distance from front edge	Finish/Color	Item No.
28 mm (1 1/8")	nickel-plated	373.66.693
37 mm (1 7/16")	nickel-plated	373.66.694
28 mm (1 1/8")	silver	373.66.993
37 mm (1 7/16")	silver	373.66.994
28 mm (1 1/8")	black	373.66.393
37 mm (1 7/16")	black	373.66.394

*Packing: 20 pcs.

Door Mounting Bracket

- For wood or aluminum frames over 35 mm (1 3/8") profile wide

Material: steel

Finish/Color	Item No.
nickel-plated	373.66.681
silver	373.66.981
black	373.66.381

*Packing: 20 pcs.

Special Door Mounting Bracket

- For use with a face frame overlay 5-piece door

Material: steel

Finish	Item No.
nickel-plated	373.66.685

*Packing: 20 pcs.

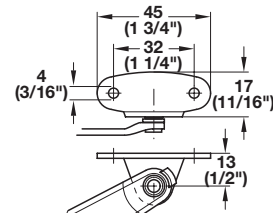
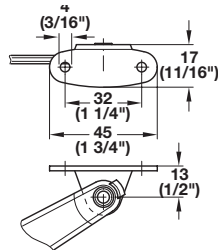
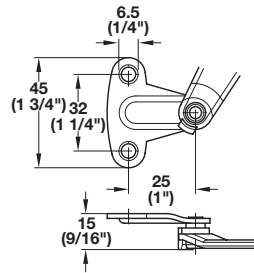

Dimensional data not binding. We reserve the right to alter specifications without notice.

Dimensions in mm
Inches are approximate