

NOTES:
1. RECOMMENDED SCREW SIZE INTO DOOR #6X 1/2"
(PROVIDED BY RAS) QTY 4

CUSTOMER DRAWING

This drawing is the property of Rev-A-Shelf (RAS) and is disclosed in confidence to the extent its subject matter is original to RAS. Any vendor receiving this drawing from RAS shall hold and use this drawing for the sole benefit of RAS and shall not disclose it to, or use or reproduce it for any third party, or perform any act adverse to the interest of RAS with respect to this drawing without the express written permission of RAS. Vendors shall not revise any physical, dimensional or performance characteristic unless authorized by Rev-A-Shelf Engineering.

REV.	DATE	BY	DESCRIPTION OF CHANGE
B	7-8-09	KRR	ECN09-073
A	6-3-09	KRR	ECN09-065

INCH [MM]	AMERICAN PROJECTION	BY	DATE	REV-A-SHELF [®] , INC.
		KRR	6-3-09	
TOLERANCES				SIZE
DECIMALS				B
.XX ±.02 [.5mm]				448BC-05
.XXX ±.005 [.13 mm]				PULL-OUT BASE ORGANIZER
FRACTIONS ±1/32 [.8 mm]				DRAWING NO.
ANGLES				448BC-05-CUSTOMER
±1/2°				SCALE
FINISH				0.210
PART NO.				SHEET
448BC-05				1 OF 2

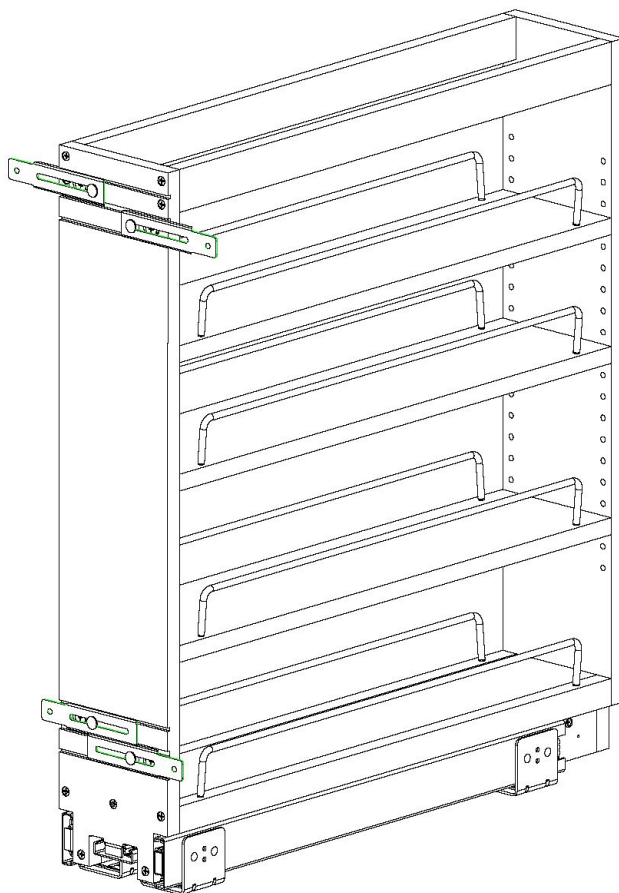

MIN CABINET OPENING	
WIDTH	5.50
DEPTH	22.62
HEIGHT	25.62

PRODUCT MAX WEIGHT RATING
BMHA STANDARD

SLIDE SPECIFICATIONS				
SLIDE TYPE	BALL BEARING	SLIDE EXTENSION	FULL	MAX WEIGHT RATING
SLIDE CLOSING	N/A	SLIDE LENGTH	500MM	
SLIDE MOUNTING	N/A	SLIDE FINISH	ZINC	100 LB

CUSTOMER DRAWING

This drawing is the property of Rev-A-Shelf (RAS) and is disclosed in confidence to the extent its subject matter is original to RAS. Any vendor receiving this drawing from RAS shall hold and use this drawing for the sole benefit of RAS and shall not disclose it to, or use or reproduce it for any third party, or perform any act adverse to the interest of RAS with respect to this drawing without the express written permission of RAS. Vendors shall not revise any physical, dimensional or performance characteristic unless authorized by Rev-A-Shelf Engineering.

					AMERICAN PROJECTION	BY	DATE	REV-A-SHELF, INC.	
					INCH [MM]	DRAWN	KRR 6-3-09		
B	7-8-09	KRR	ECN09-073					SIZE	448BC-05
A	6-3-09	KRR	ECN09-065						B
REV.	DATE	BY	DESCRIPTION OF CHANGE		TOLERANCES	MATERIAL		DRAWING NO.	448BC-05-CUSTOMER
					DECIMALS .XX ±.02 [.5mm]	FINISH		PART NO.	448BC-05
					ANGLES ±1/2°			SHEET	2 OF 2
					FRACTIONS ±1/32 [.8 mm]				