

- Required:** Eurolinx 2.0 Light ..... P/N: L-EULXW2  
 12VDC Class 2 Power Supply sold separately  
**Optional:** Inline Dimmer Module ..... P/N: L-EUL-GTD2  
 Link Cord ..... P/N: L-EULNK2  
 See other accessories below.

# Installation Instructions

## Eurolinx 2.0 LED Lights

### 4W/ft. 12VDC Dimmable

#### READ ALL INSTRUCTIONS BEFORE INSTALLING SYSTEM.

**Before beginning installation, be sure power is turned OFF to light system.**

Note: An **inline dimmer module** is offered as an option to dim or turn lights on/off. It is rated at 27W max. load, equal to 79" (2 m) of Eurolinx 2.0 lights.

Note: Maximum continuous run per starter cord is 10' (3 m) to prevent voltage drop. Maximum of 15' (4.6 m) per 60W power supply utilizing (2) starter cords.

**To begin installation, roughly lay out lighting system to help verify final positioning of all components and cord lengths.**

1. Install **class 2 12VDC power supply** concealed from view. *Keep power off to power supply until complete system is installed.*

2. Determine exact position of light fixture(s) and, if desired, an optional inline dimmer module and mark positions.

*Note: Inline dimmer module must be placed prior to the light on the input side! (see #1). The module comes with (1) u-clip for mounting.*

3. To install light, use (2) **u-clips** with built-in magnets or screws provided - so light can mount to either metal or wood-type surfaces.

For metal surfaces, snap u-clips onto light then position onto metal surface.

For wood-type surfaces, drill 1/16" (1.5 mm) pilot holes for screws and mount u-clips. Then snap light fixture into u-clips.

To attach u-clips onto light, snap short side of u-clip into small groove running full-length on one side of light body. Then long side of u-clip snaps over the light body (see #2).

*Note: The light's angle is directional. When powered from the left the small groove and the light faces toward you. When powered from the right the small groove and the light faces away from you (see #3).*

4. Use **starter cord** to power first light (see #4). See "Connecting Starter Cords" information below (†). If spacing is more than 79" (2 m), a **12VDC L-LINKD extension cord** may be used. Cords can either: (a) feed through a hole in mounting surface (shelf); or (b) run along surface. **Starter cord** only requires 3/16" (5 mm) hole (before AMP® connector is attached †).

*Note: Maximum length of starter cords from power supply to light should not exceed 16' (5 m). Longer cords could result in poor light quality.*

5. Light fixtures can be linked together using a **link cord** (see #5a) or can be linked directly, light-to-light with a **back-to-back link** (see #5b). Cords can either: (a) feed through a hole in mounting surface (shelf); or (b) run along surface. **Link cord** requires 1-1/4" (32 mm) hole.

6. Continue mounting light fixtures as needed, connecting light-to-light or using link cords. Additional light runs can be connected to the power supply.

*Note: Use insulated staples or plastic ties to secure all loose wires.*

7. Finally, turn power on to power supply.

#### (†) Connecting Starter Cords:

Starter cords come with a male AMP® connector unattached to help route wires through smaller holes if needed. To attach, push needle ends of starter cord wires into AMP® connector until completely seated.

**IMPORTANT!** Make sure to match polarity (+) and (-) of the wires to the AMP® connector. See markings on wires and connector (see #6).

**Included:** Starter cord 79" (2 m), AMP® connector, (1) back-to-back link (P/N: L-EUL2-BTB-GY-1), and (2) mounting u-clips are included with each light.

**Accessories:** Link cord (P/N: L-EULNK2) available in 2" (5 cm), 6" (15 cm), 10" (25 cm), 24" (60 cm), 48" (120 cm), or 72" (180 cm) lengths; and inline dimmer module (P/N: L-EUL-GTD2).

Tresco® offers other accessories including: switches, dimmers and 12VDC extension cords (used to lengthen starter cords only).

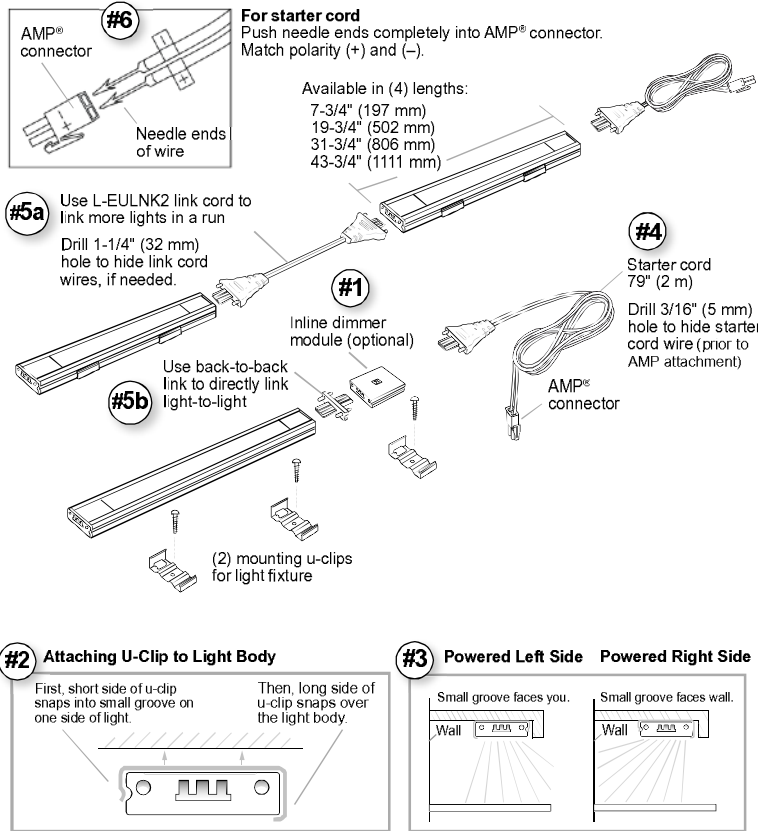

## IMPORTANT SAFETY INSTRUCTIONS

**CAUTION: To reduce the risk of fire, electric shock, or injury to persons:**

- Maximum 60W class 2 12VDC power supply powers up to 15' (4.6 m) of Eurolinx 2.0 lights; maximum single continuous run should not exceed 10' (3.0 m).
- LED are not replaceable.
- LED lights are bright. Do not look directly at lights.
- Not intended to be used in damp locations or outdoor areas.
- Not intended for recessed installation in ceilings or soffits.
- Do not conceal 120V power supply cord or power supply inside a wall, ceiling, soffit, or similar permanent structure, unless consulting a licensed electrician.
- Use only insulated staples or plastic ties to secure ALL loose cords.
- Route and secure cords so that they will not be pinched or damaged when the cabinet is pushed to the wall.
- A licensed electrician should be consulted for wiring through ceilings, soffits, or walls. All wiring must follow NEC regulations.

This light is intended to be used as a cabinet light on wood, particle board or other structurally sound, heat resistant surface. Care should be taken during and after installation to avoid contact of light with wiring, cord, or any combustible material.

Save these instructions for future reference.  
 For technical assistance: 1-800-227-1171



**Tresco® Lighting**  
 12400 Earl Jones Way  
 Louisville, KY 40299  
 Tel: 800-227-1171  
 Fax: 502-491-2215



Email: cservice@trescolighting.com  
 Web: www.trescolighting.com