

Required: Eurolinx Light P/N: L-EUL
DC Power Supply (60W) . . . P/N: L-DC-ELT60-CON

Optional: Inline Dimmer Module P/N: L-EUL-GTD
Link Cord P/N: L-EULNK

See other Accessories below.

Installation Instructions

Eurolinx LED Lights

4W/ft. 12VDC Dimmable

READ ALL INSTRUCTIONS BEFORE INSTALLING SYSTEM.

Before beginning installation, be sure power is turned OFF to light system.

Note: An **Inline Dimmer Module** is offered as an option to dim or turn lights on/off. It is rated at 27W max. load, equal to 2m (79") of Eurolinx Lights.

Note: Maximum continuous run is 3.0m (10') to prevent voltage drop.
Maximum 4.6m (15') per 60W Power Supply.

To begin installation, roughly lay out lighting system to help verify final positioning of all components and cord lengths.

1. Install **Power Supply** and **Mounting Block** concealed from view. Do not plug Power Cord into 120V power source yet (see fig. #1).
2. Determine exact position of Light Fixture(s) and, if desired, an optional **Inline Dimmer Module** and mark positions.

Note: *Inline Dimmer Module must be placed prior to the Light on the input side!* (see #2). The Module comes with (1) U Clip for mounting.

3. To install Light, use (2) **U Clips** with built-in magnets or screws provided - so Light can mount to either metal or wood-type surfaces.

For metal surfaces, snap U Clips onto Light then position onto metal surface.

For wood-type surfaces, drill 1.5mm (1/16") pilot holes for screws and mount U Clips. Then snap Light Fixture into U Clips.

To attach U Clips onto Light, snap short side of U Clip into small groove running full-length on one side of light body. Then long side of U Clip snaps over the light body (see #3).

Note: *The Light's angle is directional. When powered from the left the small groove and the light faces toward you. When powered from the right the small groove and the light faces away from you (see #4).*

4. Use **Starter Cord** from first Light and snap into **Mounting Block** (see #5). See "Connecting Starter Cords" information below (†). If spacing is more than 2m (79"), a **12V L-LINKD Extension Cord** may be used. Cords can either: (a) feed through a hole in mounting surface (shelf); or (b) run along surface. **Starter Cord** only requires 5mm (3/16") hole (before AMP® Connector is attached †).

Note: *Maximum length of Starter Cords from Power Supply to light should not exceed 5m (16'). Longer cords could result in poor light quality.*

5. Light Fixtures can be linked together using a **Link Cord** (see #6a) or can be linked directly, light-to-light with a **Back-to-Back Link** (see #6b). Cords can either: (a) feed through a hole in mounting surface (shelf); or (b) run along surface. **Link Cord** requires 32mm (1-1/4") hole.
6. Continue mounting Light Fixtures as needed, connecting light-to-light or using Link Cords. Additional light runs can be connected to the Mounting Block.
Note: *Use insulated staples or plastic ties to secure all loose wires.*
7. Finally, plug Power Cord into 120V power source.

(†) Connecting Starter Cords:

Starter Cords come with a male AMP® Connector unattached to help route wires through smaller holes if needed. To attach, push needle ends of Starter Cord wires into AMP® Connector until completely seated. **IMPORTANT!** Make sure to match polarity (+) and (-) of the wires to the AMP® connector. See markings on wires and connector (see #7).

Included: Starter Cord 2m (79"), AMP® Connector, (1) Back-to-Back Link (P/N: L-EULNK-BTB), and (2) Mounting U Clips are included with each Light.

Accessories: Link Cord (P/N: L-EULNK) available in 5cm (2"), 15cm (6"), 25cm (10"), 60cm (24"), 120cm (48"), or 180cm (72") lengths; and **Inline Dimmer Module** (P/N: L-EUL-GTD).

TRESCO® offers other accessories including: Switches, Dimmers and 12V Extension Cords (used to lengthen Starter Cords only).

Other Power Supply options available.

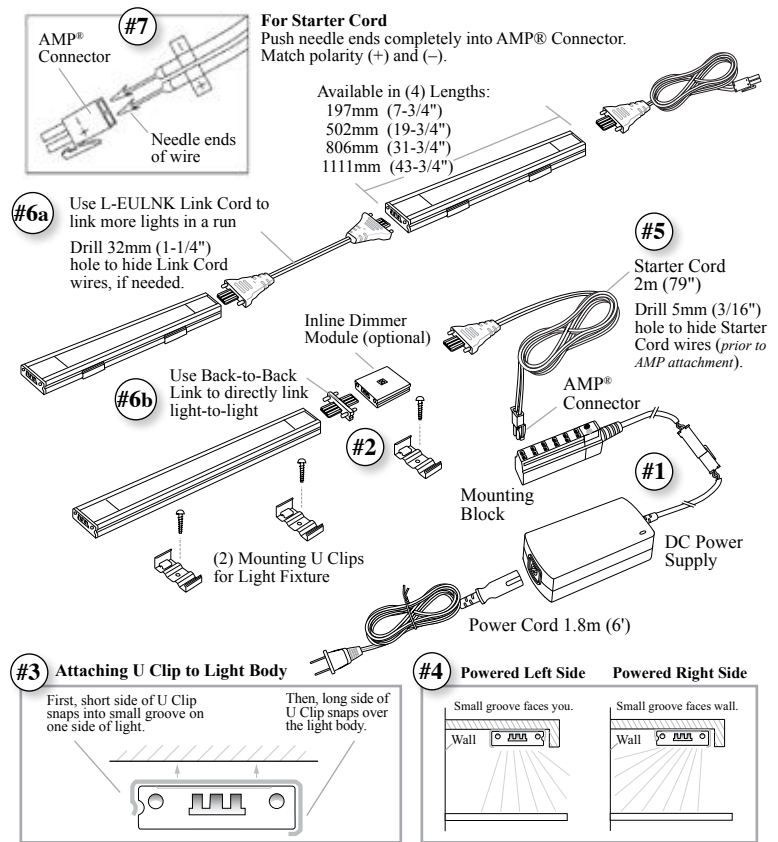

IMPORTANT SAFETY INSTRUCTIONS

CAUTION: To reduce the risk of fire, electric shock, or injury to persons:

- Tresco® 60W Class 2 12V DC Power Supply powers up to 4.6m (15') of Eurolinx Lights; maximum single continuous run should not exceed 3.0m (10').
- LED are not replaceable.
- LED lights are bright. Do not look directly at lights.
- Not intended to be used in damp locations or outdoor areas.
- Not intended for recessed installation in ceilings or soffits.
- Do not conceal 120V Power Supply Cord or power supply inside a wall, ceiling, soffit, or similar permanent structure, unless consulting a licensed electrician.
- Use only insulated staples or plastic ties to secure ALL loose cords.
- Route and secure cords so that they will not be pinched or damaged when the cabinet is pushed to the wall.
- A licensed electrician should be consulted for wiring through ceilings, soffits, or walls. All wiring must follow NEC regulations.
- This portable lamp has a polarized plug on the Power Supply Cord (one blade is wider than the other) as a feature to reduce the risk of electric shock. This plug will fit in a polarized outlet only one way. If the plug does not fit fully in the outlet, reverse the plug. If it still does not fit, contact a qualified electrician. Never use with an extension cord unless plug can be fully inserted. Do not alter the plug.

This light is intended to be used as a cabinet light on wood, particle board or other structurally sound, heat resistant surface. Care should be taken during and after installation to avoid contact of light with wiring, cord, or any combustible material.