

Installation Instructions

Elli™ Low Voltage Linkable LED Light Strips

****Read and follow all safety and installation instructions carefully****

This light is intended for interior use under shelves, in cabinets, bookcases, store fixtures, on particleboard or other structurally sound, heat resistant surfaces.

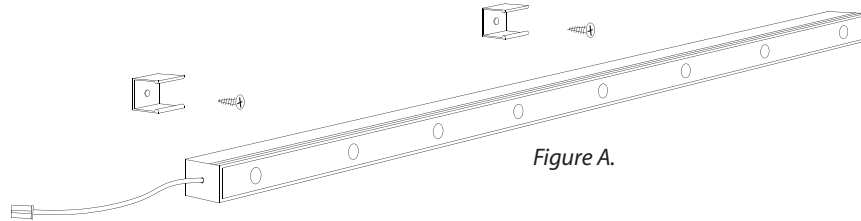

Figure A.

To install LED Strip Lighting:

Before beginning any wiring, be sure power is turned OFF to transformer.

1. Determine where to install Class II DC transformer (DC-ELT60-CON). Be sure wires will properly reach the transformer and 120V power source.
2. Position and mount 12V 60W, DC transformer (DC-ELT60-CON).
3. Determine the location of the lights.
4. Remove mounting clips (square LED only) and screws from packaging.
5. Use two U-Clips (see figure A.) and mount to surface with enclosed mounting screws. Use double sided tape and/or screws for V-shape LED (see figure B).

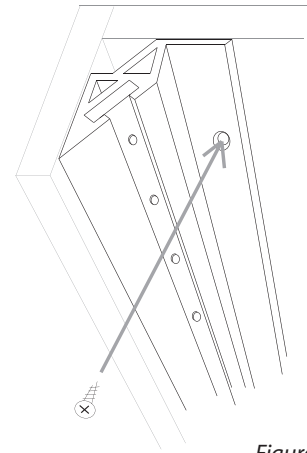
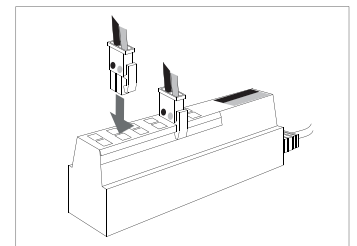
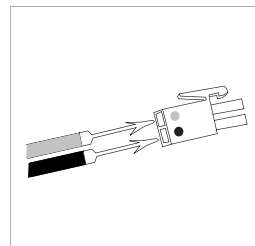

Figure B.

6. Run wire to transformer. Snap wire in to transformer block. Caution: Transformer must be turned off when making connections. 60W max per transformer. Be sure to keep polarity correct: (+)Red with (+)Red, (-)Black with (-)Black
7. Double-check all connections and then turn power on to transformer.



**** Max per single run: 12' ****

IMPORTANT SAFETY INSTRUCTIONS

CAUTION: To reduce the risk of fire, electric shock, exposure to excessive UV radiation, or injury to persons:

- Use only in dry indoor locations. Not for use where exposed to the weather.
- Wiring and materials should conform to national (NEC) and local electrical codes.
- A licensed electrician should be consulted for wiring through ceilings, soffits, or walls.

