



FVN8093-D

VISTA

INSTALLATION GUIDE

kitchensource.com
1.800.667.8721



FRESCA®

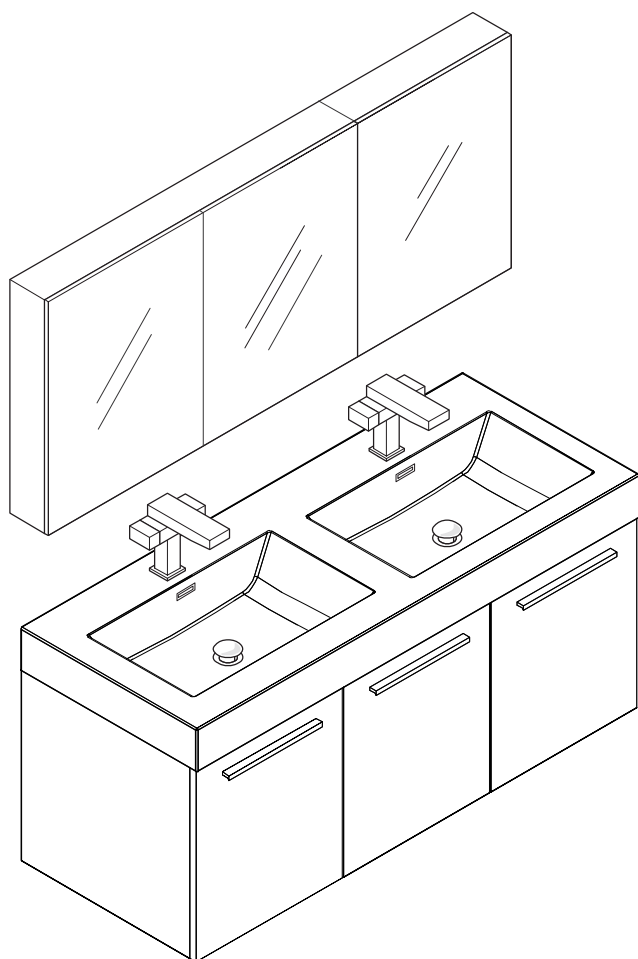

Medicine Cabinet

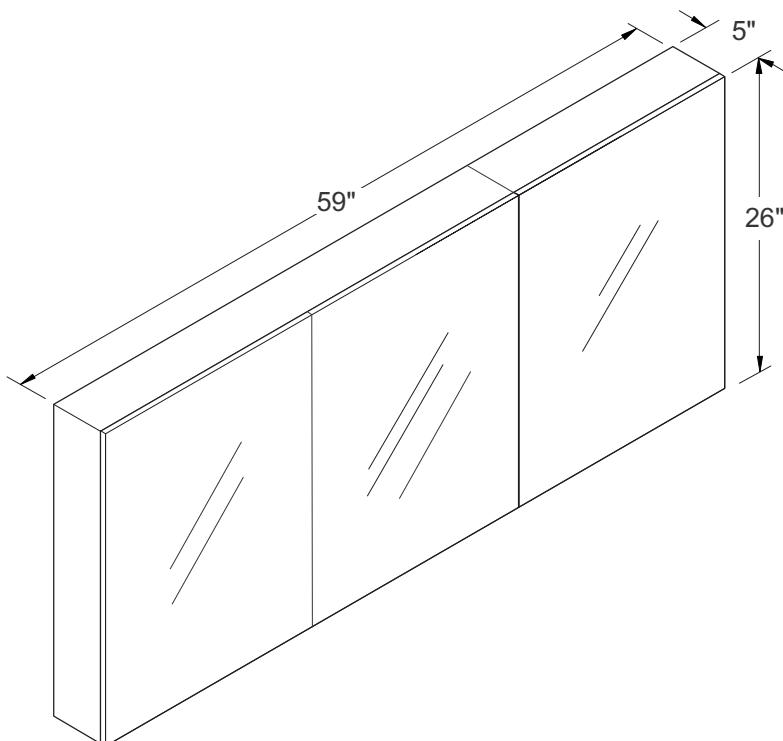

Vanity Front

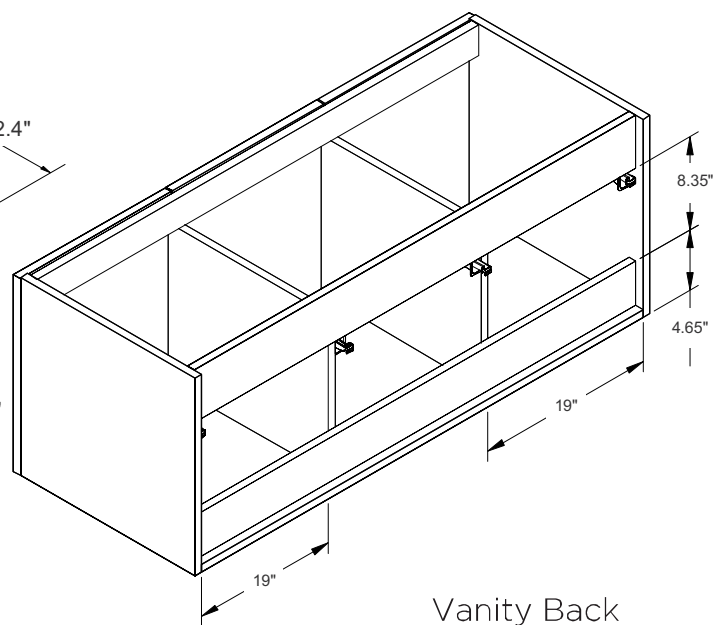
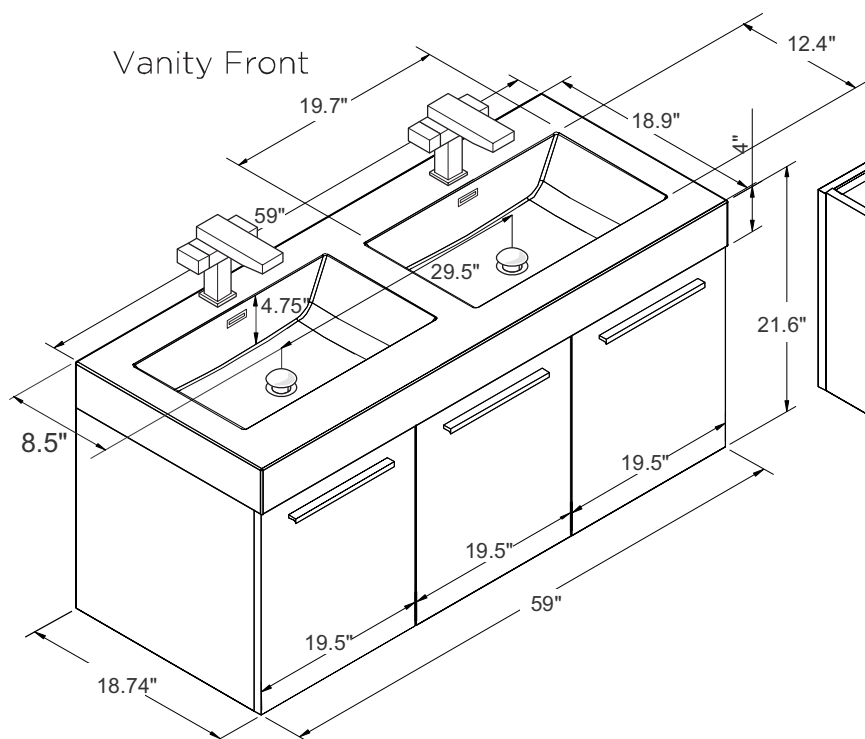

Vanity Back



ALL DIMENSIONS & SPECIFICATIONS
ARE APPROXIMATE AND SUBJECT TO
CHANGE WITHOUT NOTICE.

TOOLS FOR ASSEMBLY

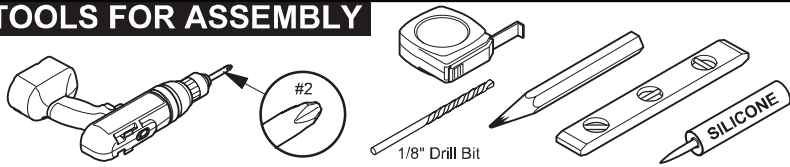

PARTS

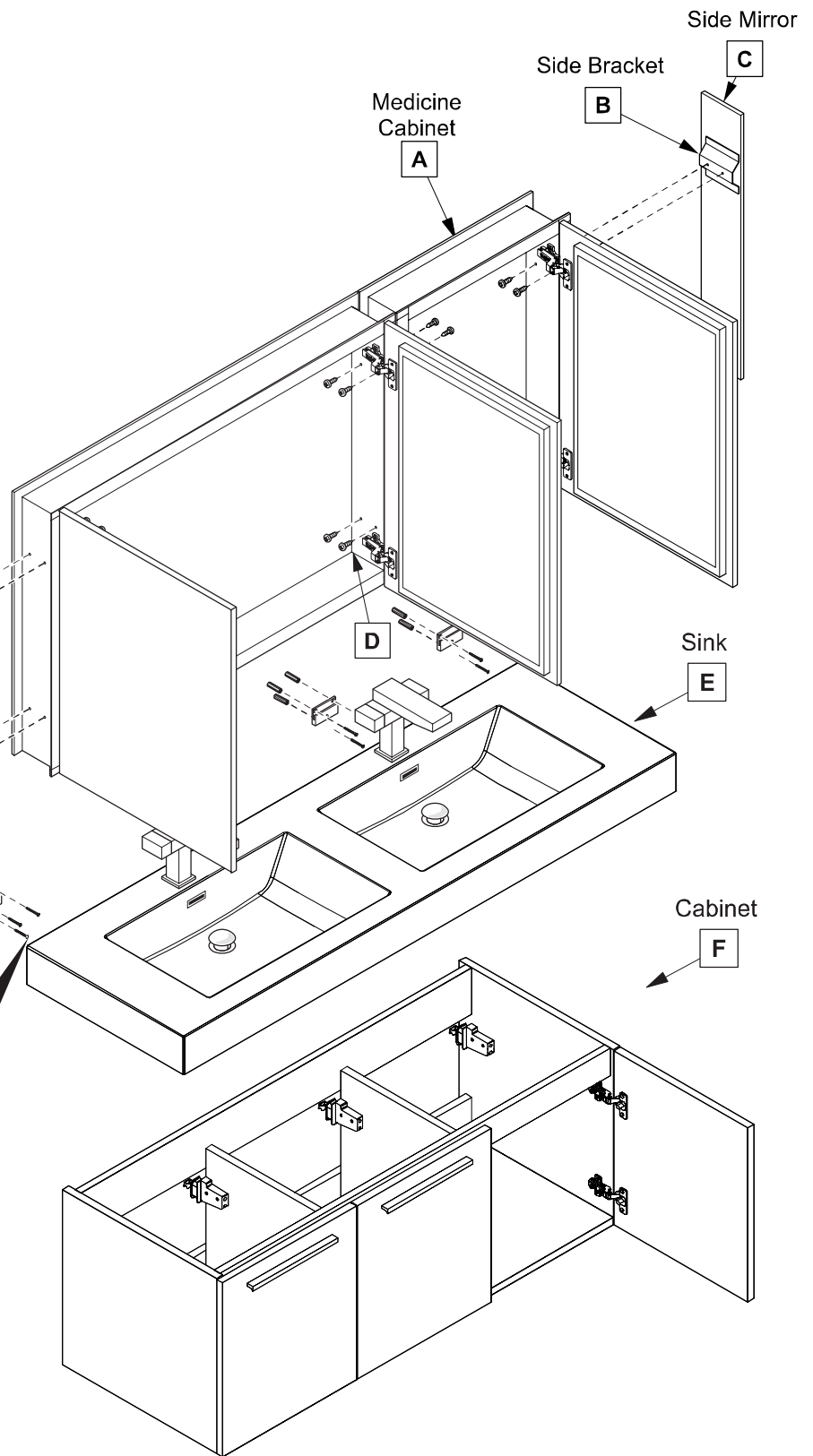
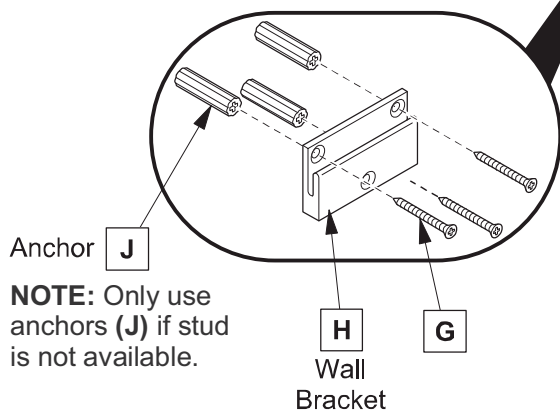
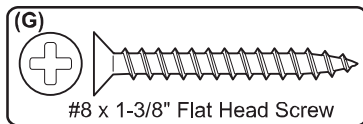
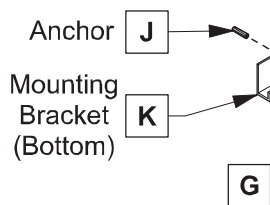
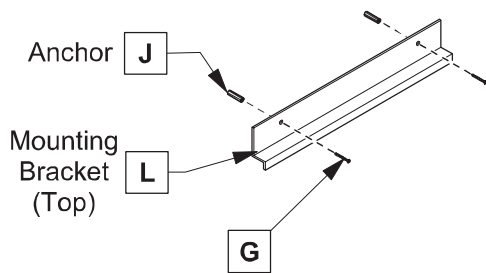

1

Locate cabinet (F) & mark location on the wall

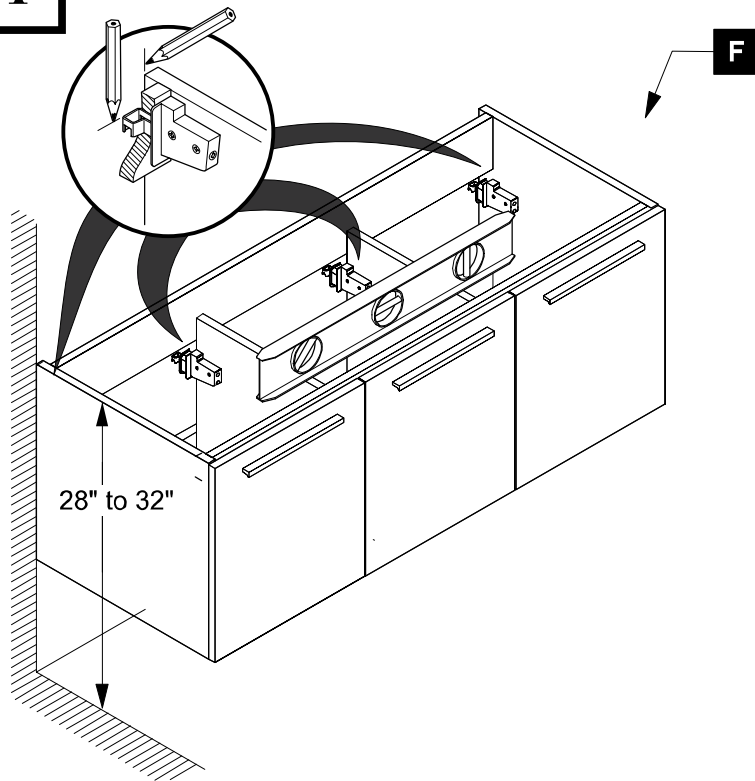

2

Install wall brackets (J)

IMPORTANT: Consult an expert for the proper screws/bolts to use when attaching to various wall constructions. Screws provided do not attach to all wall construction types.

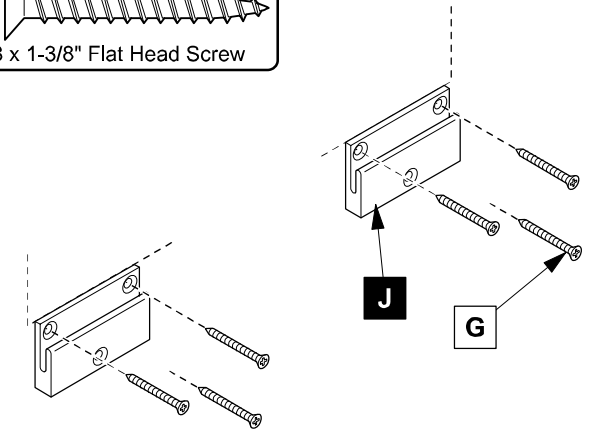
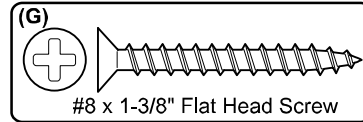

3

NOTE: If necessary remove drawers to access connection mechanism.

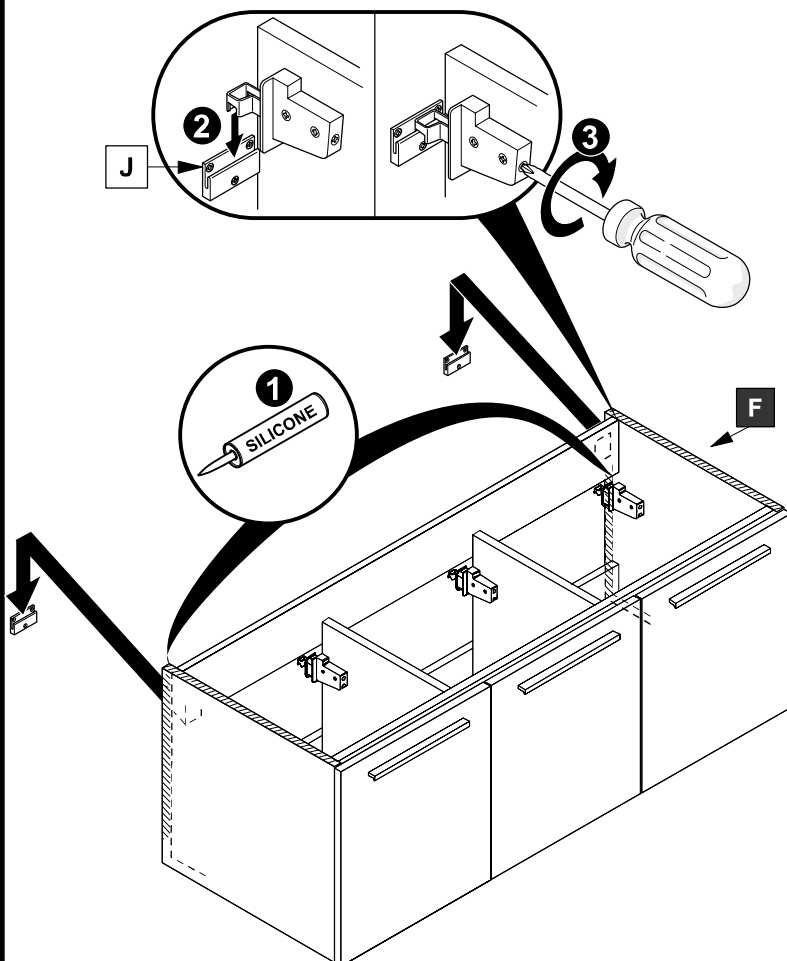

4

Apply silicone and install sink (E)

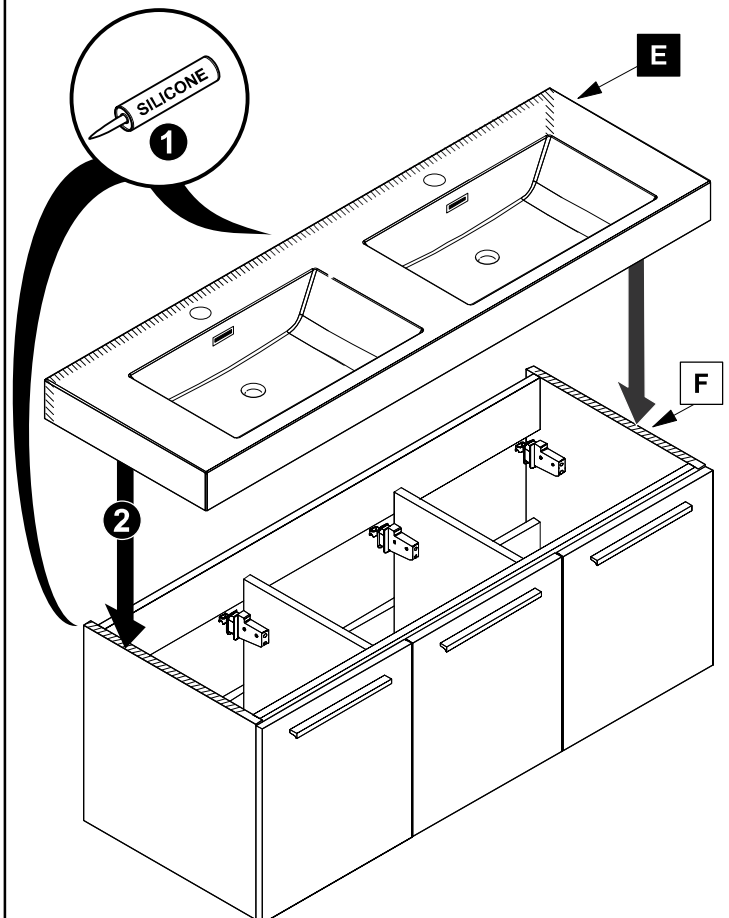

MEDICINE CABINET INSTALLATION

1

Install side mirrors (C)

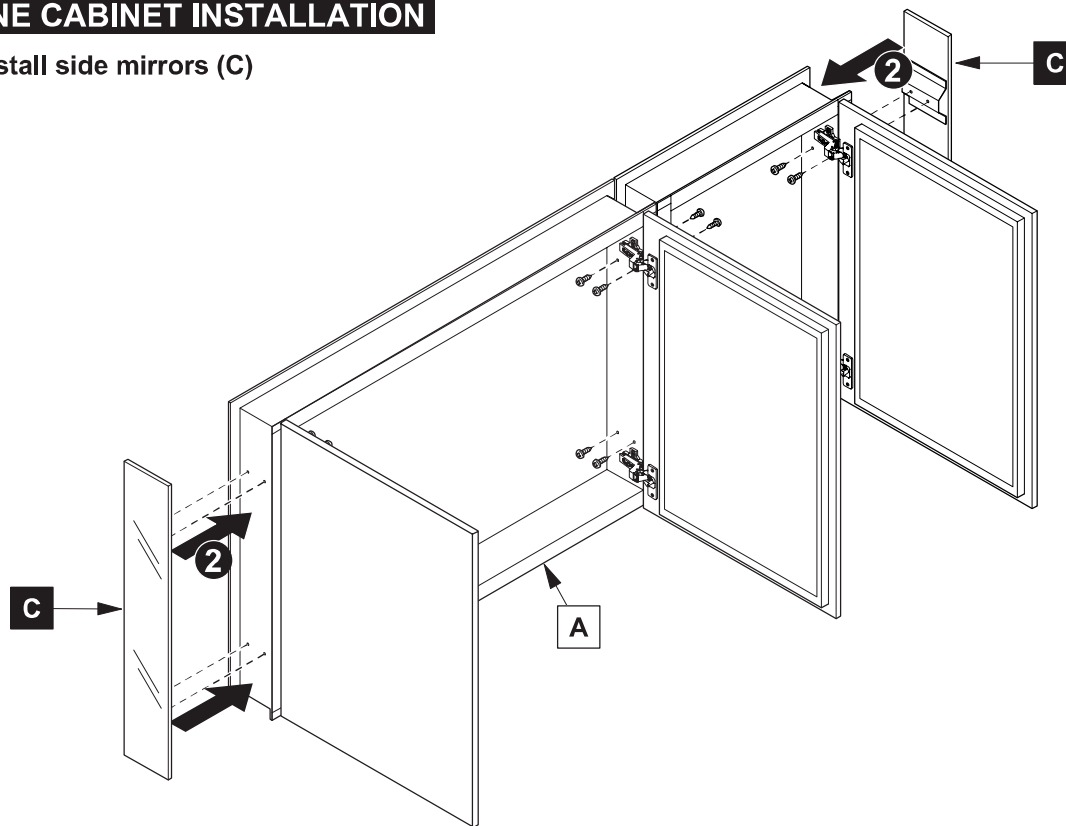

2

Mark cabinet (A) location

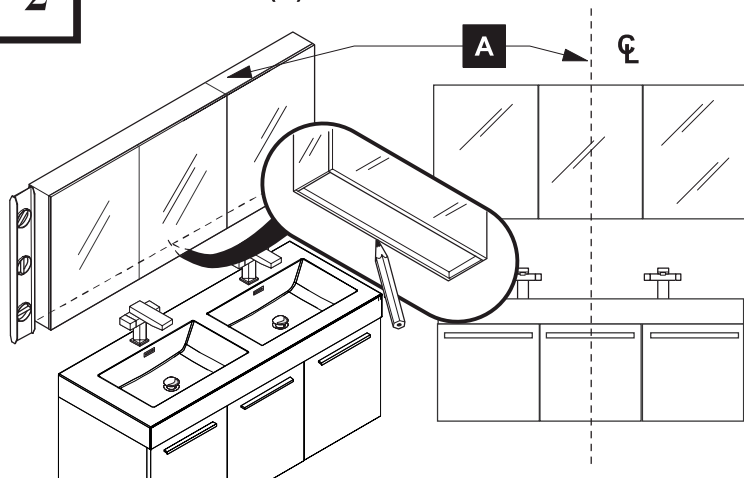

4

Install cabinet (A) and top bracket (L)

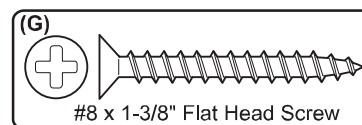

3

Install bottom bracket (K)

IMPORTANT: Consult an expert for the proper screws/bolts to use when attaching to various wall constructions. Screws provided do not attach to all wall construction types.

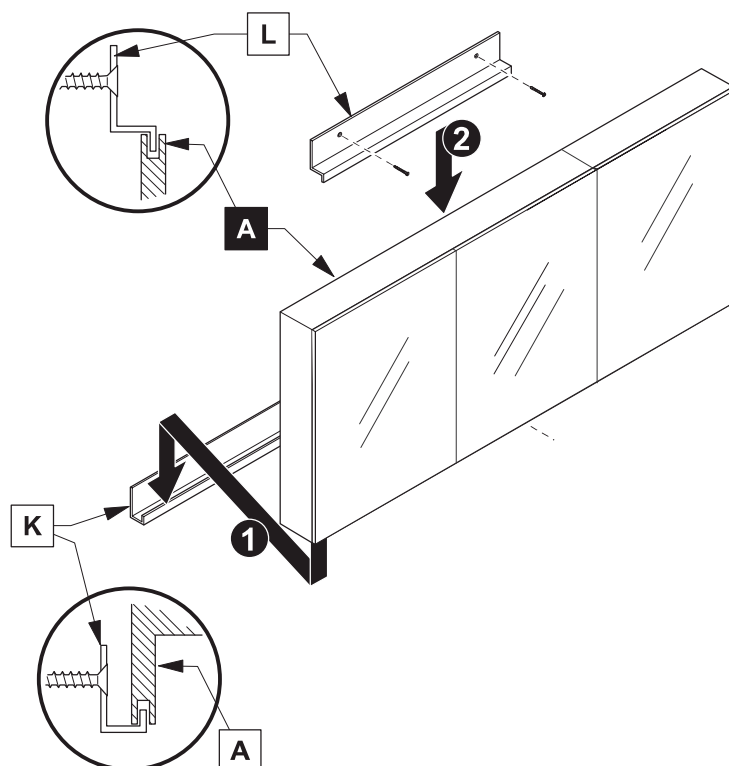
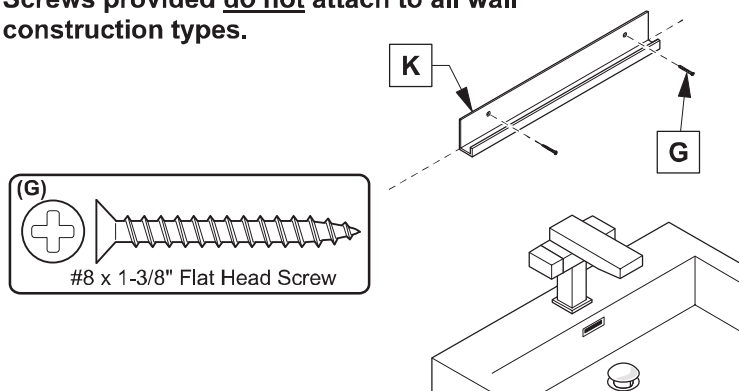

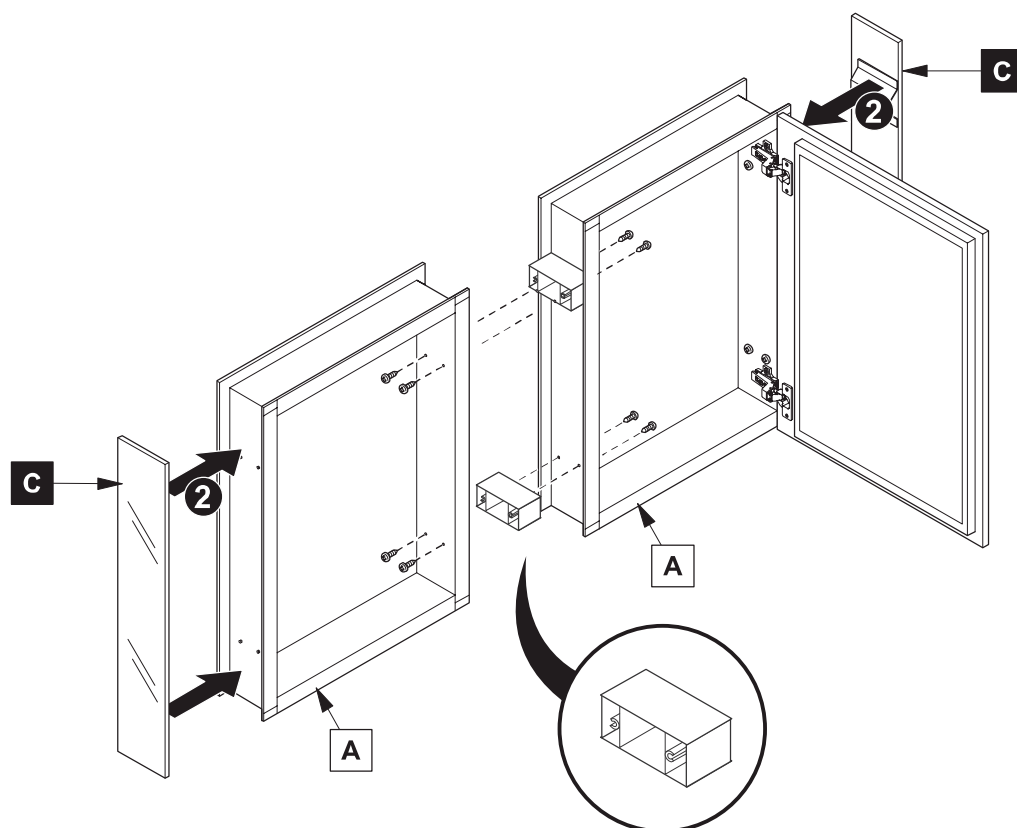

P-TRAP & POP-UP

INSTALLATION INSTRUCTIONS

Your item may appear slightly different from the illustration.

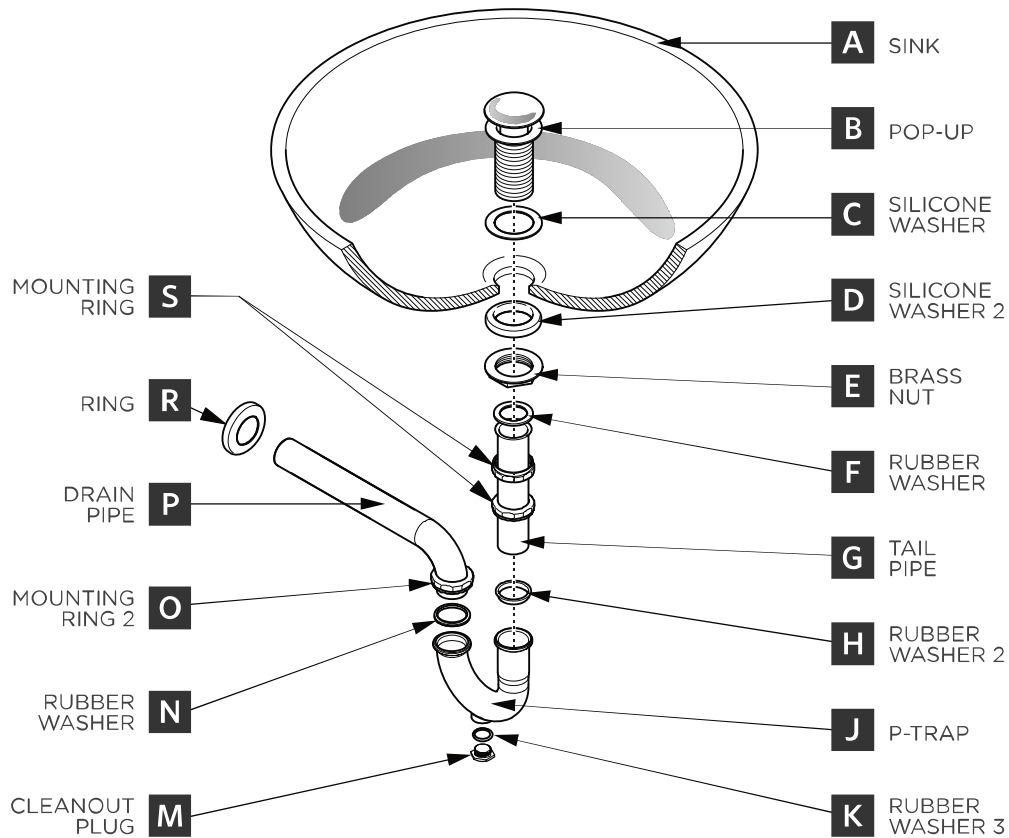

POP-UP INSTALLATION

FOR SINKS WITHOUT OVERFLOW

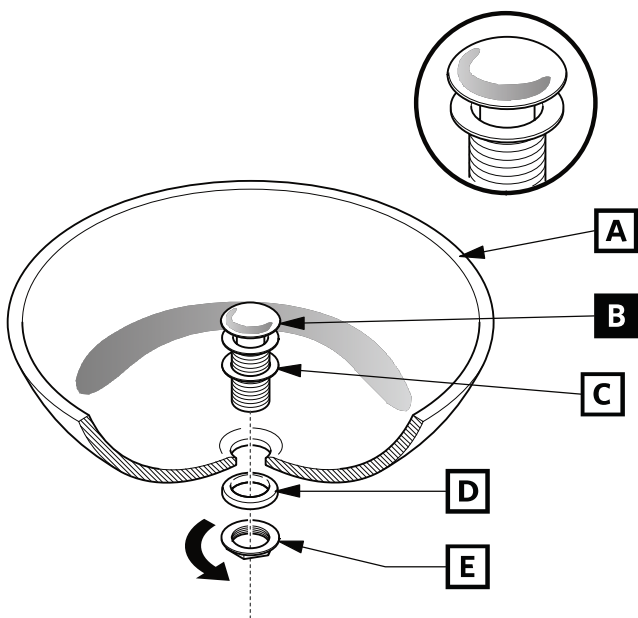

OR

FOR SINKS WITH OVERFLOW

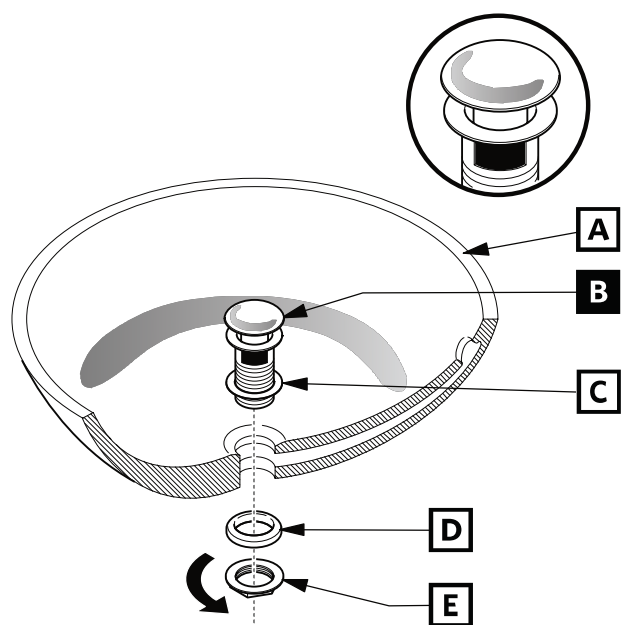

P-TRAP INSTALLATION

1

Install tail pipe (G)

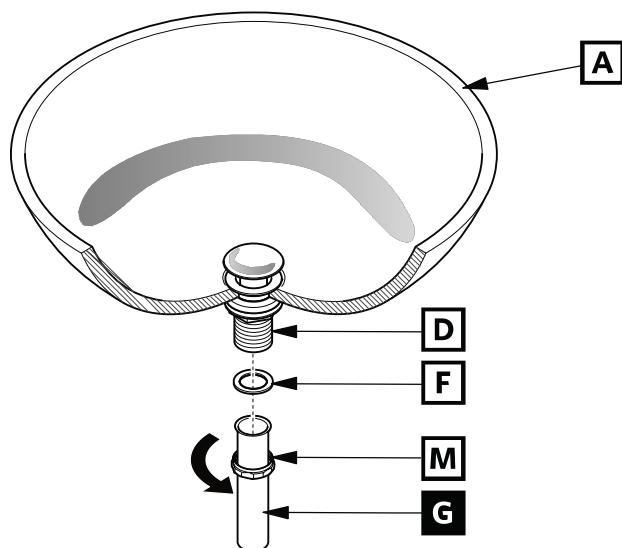

2

Install P-trap (J)

