



FORMOSA

INSTALLATION GUIDE

FVN31-3030ACA

CONTENTS:

Mirror	FMR3126ACA	PAGE 2
Cabinet	FCB3130ACA	PAGE 3
Sink	FCT2061WH-D-CMB	PAGE 3

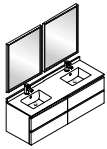

FVN31-3030ACA FORMOSA INSTALLATION GUIDE

kitchensource.com
1.800.667.8721



FVN31-3030ACA
Vanity Front

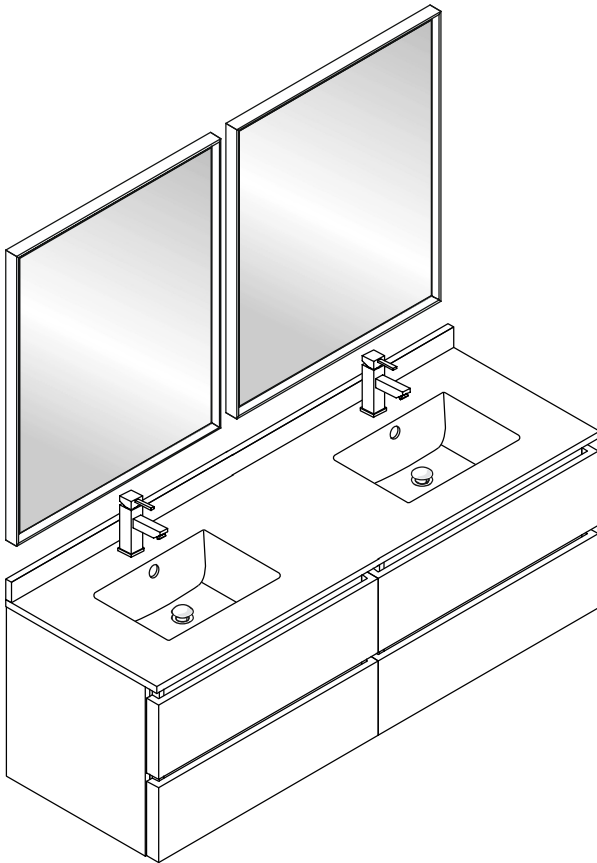

FMR3126ACA
Mirror Front

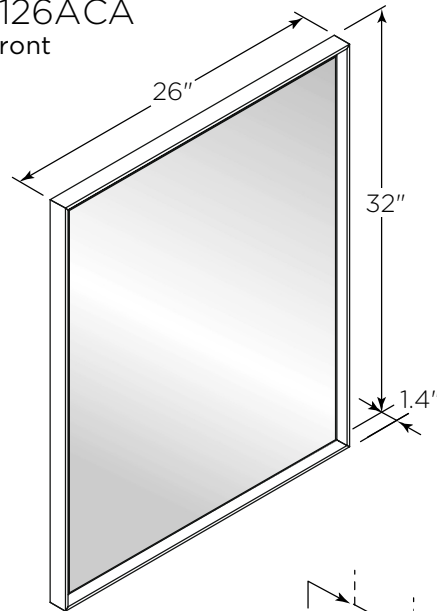

FCT2061WH-D-CMB
Counter Top Front

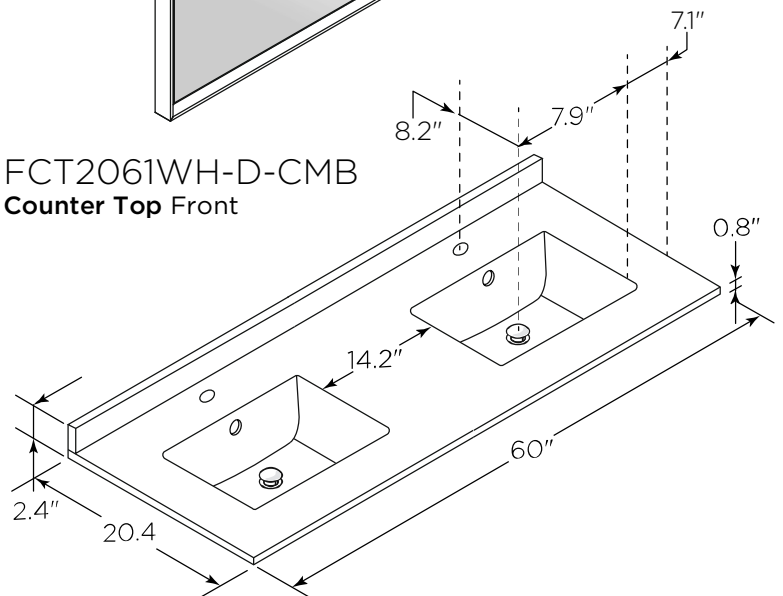

FCB3130ACA (X2)
Cabinet Front

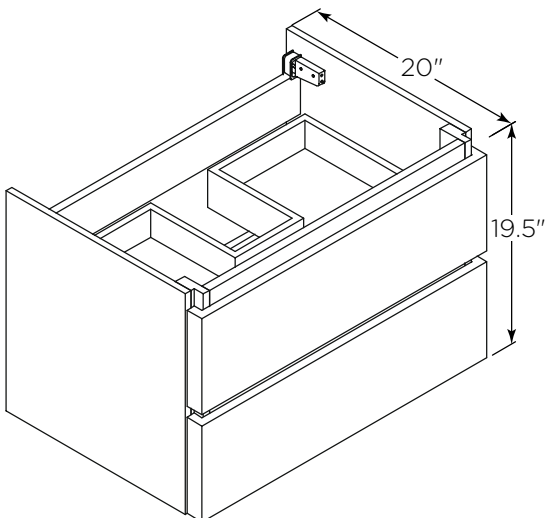

FCB3130ACA
Cabinet Back

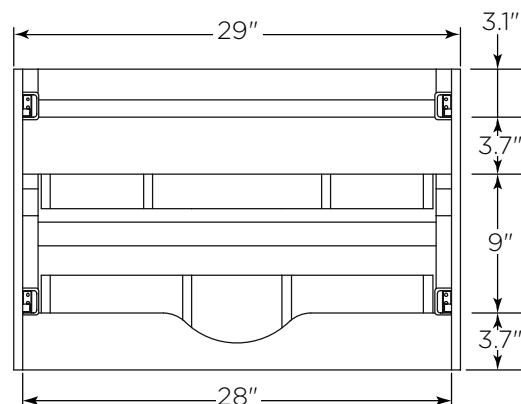

NOTE: All dimensions & specifications are approximate and subject to change without notice.



FVN31-3030ACA | FORMOSA | INSTALLATION GUIDE

PAGE 1

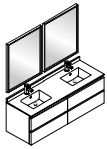

FVN31-3030ACA FORMOSA INSTALLATION GUIDE

|||kitchensource.com
1.800.667.8721



TOOLS FOR ASSEMBLY

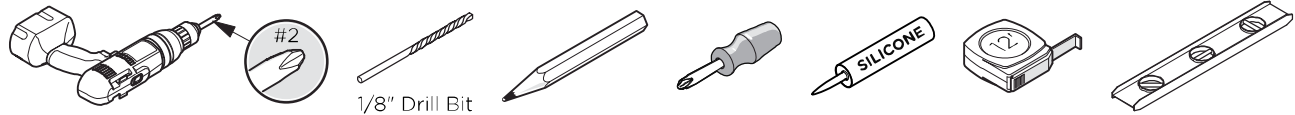

MIRROR INSTALLATION

- 1** Measure distance between the holes and mark it on the wall using a level.

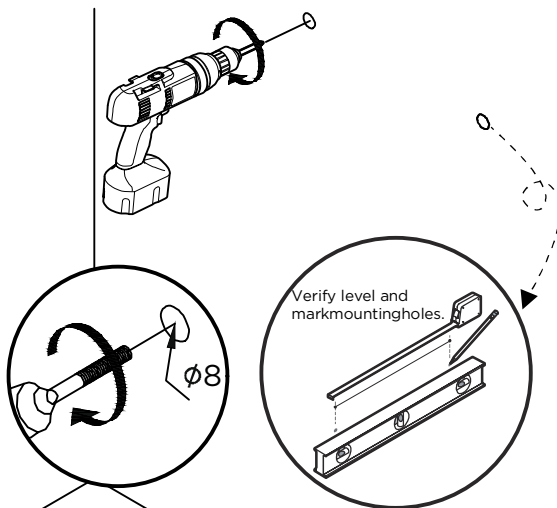

- 2** Press the anchors into the holes.

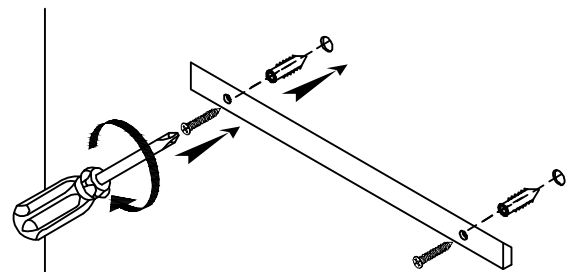

IMPORTANT: Consult an expert for the proper screws/bolts to use when attaching to various constructions. Screws provided do not attach to all wall construction types. Anchors are not required if brackets are installed in stud.

- 3** Hang mirror on the screws.

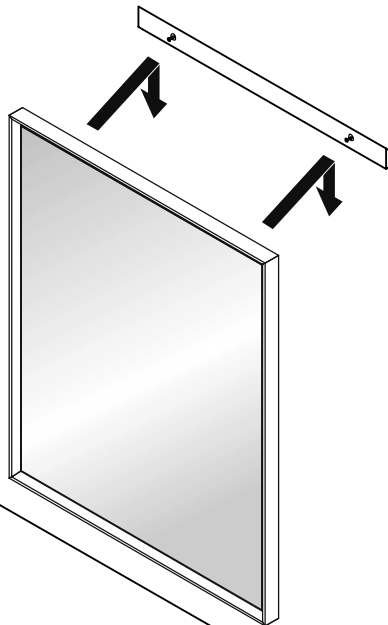

FVN31-3030ACA | FORMOSA | INSTALLATION GUIDE

PAGE 2

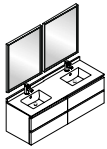

FVN31-3030ACA FORMOSA INSTALLATION GUIDE

::kitchensource.com
1.800.667.8721



CABINET AND SINK INSTALLATION

1

Mark anchor mounting hole locations on wall as shown. Drill holes in the finished wall as required.

IMPORTANT: Consult an expert for the proper screws/bolts to use when attaching to various constructions. Screws provided do not attach to all wall construction types. Anchors are not required if brackets are installed in stud.

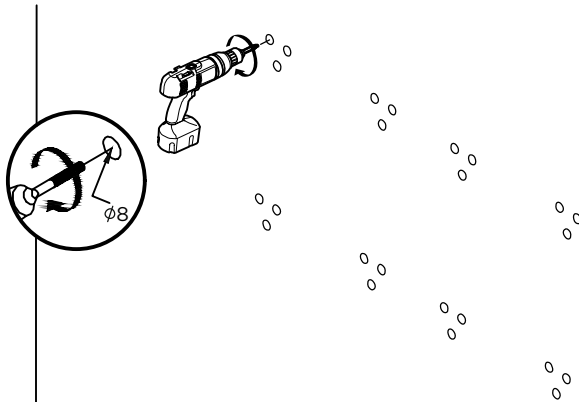

2

Attach cabinet to the wall with the screws. Insert the anchor (1) into the holes and secure the wall bracket (2) with the screws (3).

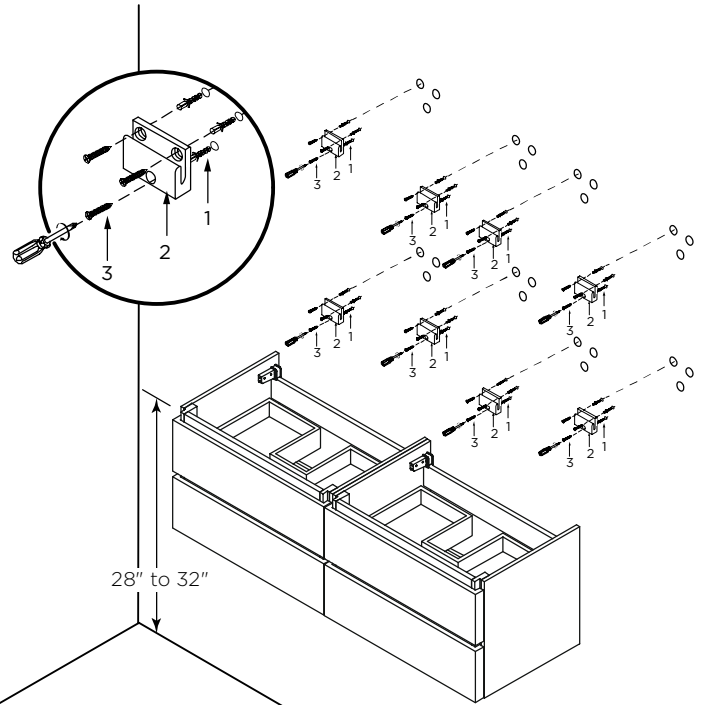

3

Install sink.

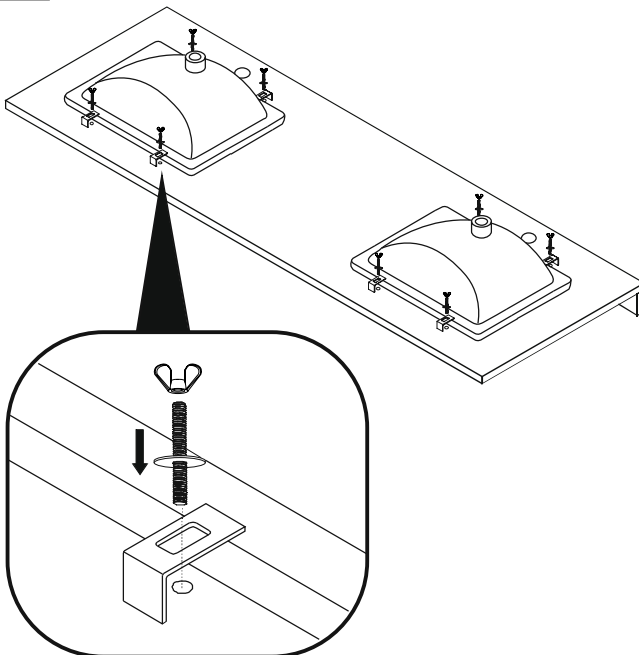

4

Apply a bead of silicone on the top of the cabinet (A) and place sink (B) on the cabinet.

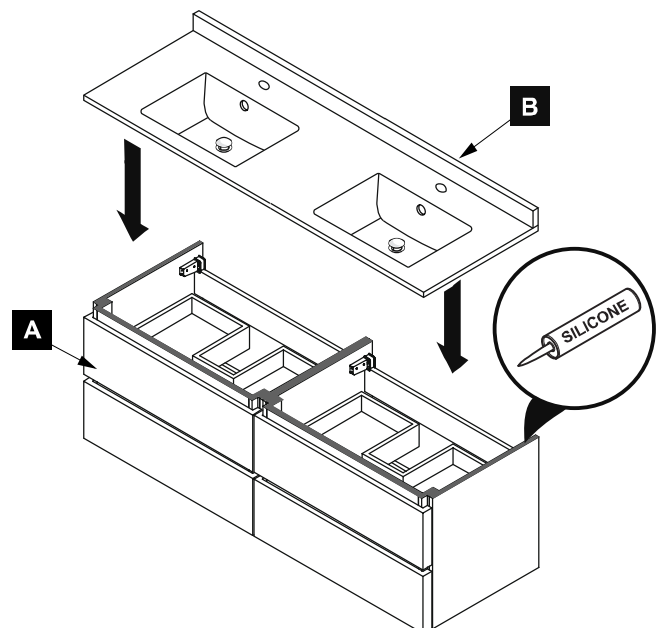

FVN31-3030ACA | FORMOSA | INSTALLATION GUIDE

PAGE 3

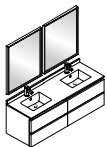

DRAWER REMOVAL & INSTALLATION

REMOVAL

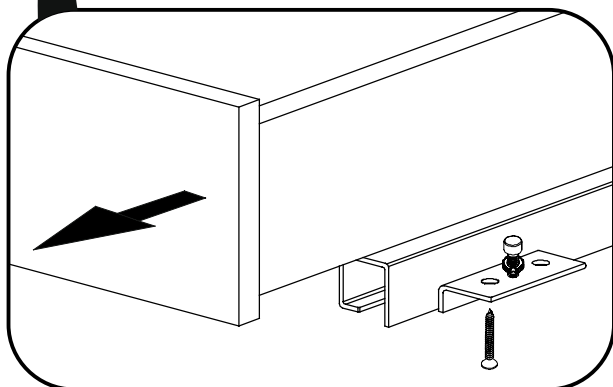
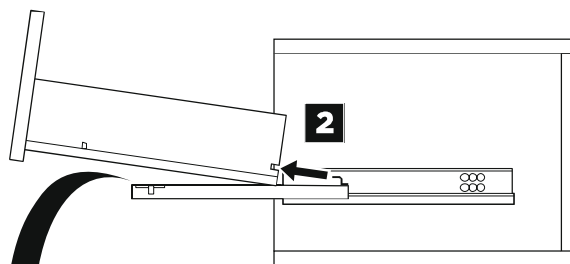
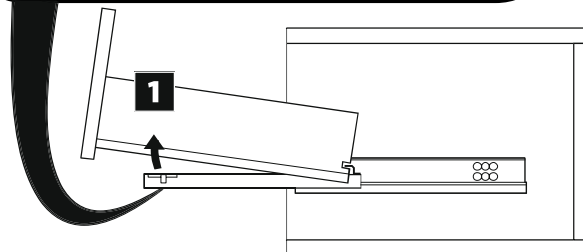
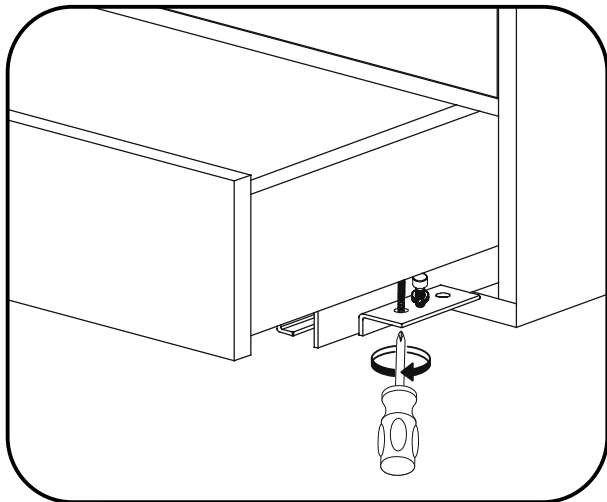

INSTALLATION

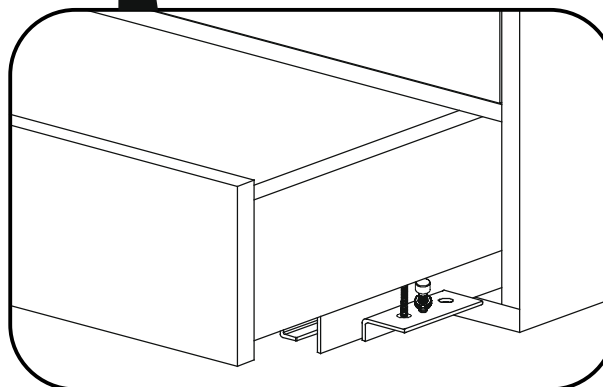
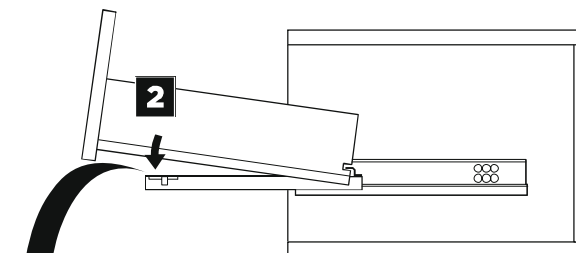
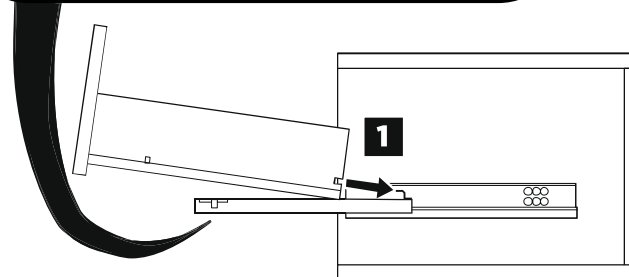
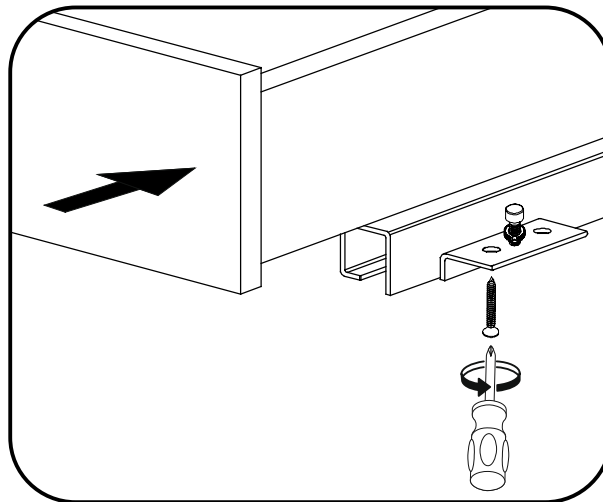

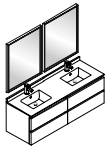

P-TRAP AND POP-UP INSTALLATION INSTRUCTIONS

NOTE:

Your item may appear slightly different from the illustration.

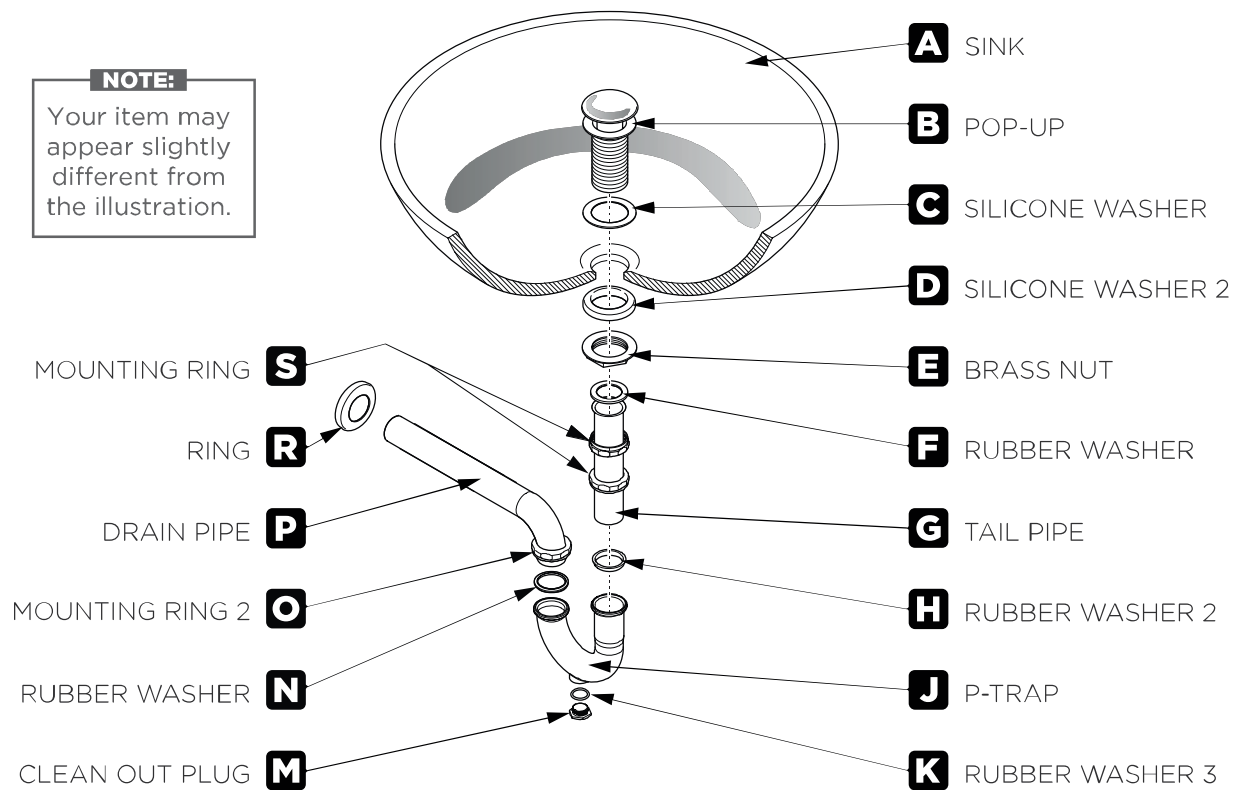

POP-UP INSTALLATION INSTRUCTIONS

FOR SINKS WITHOUT OVERFLOW

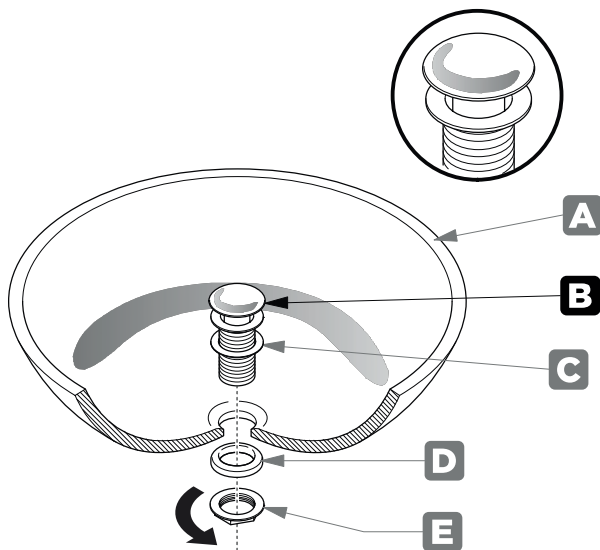

OR

FOR SINKS WITH OVERFLOW

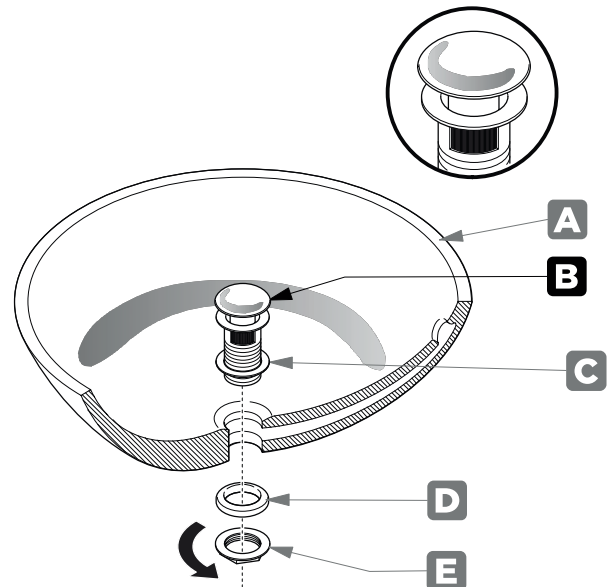



©2018 FRESCA™ All rights reserved. This material may not be reproduced, displayed, modified or distributed without the express prior written permission of the copyright holder.