

Häfele Aquasys



Häfele Aquasys Spiegel	100-240V~ System	K	W		
ML8001/2700-4000/2700/S02/H22/0750/900x600	983.19.510	2700/4000K	95W	600*900	13,3
ML8001/2700-4000/2700/S04/H22/0750/900x900	983.19.520	2700/4000K	102W	900*900	18,4
ML8001/2700-4000/2700/S04/H25/0650/1200x900	983.19.530	2700/4000K	111W	1200*900	23,78

	A	B	C	D	E	F	G
983.19.510		1	1	3	3	8	8
983.19.520	1	1	1	3	3	8	8
983.19.530	1	1	1	5	5	12	12

D

E

F

G

i

IP44

1 8 mm

2

3

4a

4b

HDE 20.03.2018

Frontbeleuchtung **Éclairage frontal** **Illuminazione anteriore**
Front lighting **Illuminación frontal** **Фронтальное освещение**

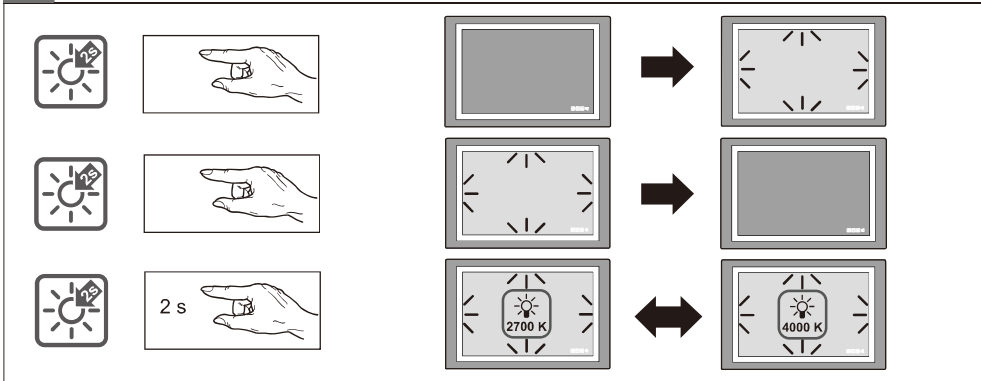

Hintergrundbeleuchtung **Rétro-éclairage** **Retroilluminazione**
Background lighting **Illuminación de fondo** **Задняя подсветка**

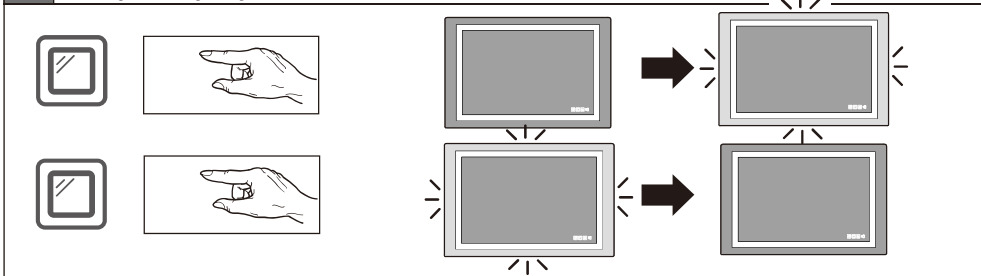

Spiegelheizung **Chauffage du miroir** **Specchio riscaldato**
Demister **Calefacción antivaho** **Отопление зеркала**

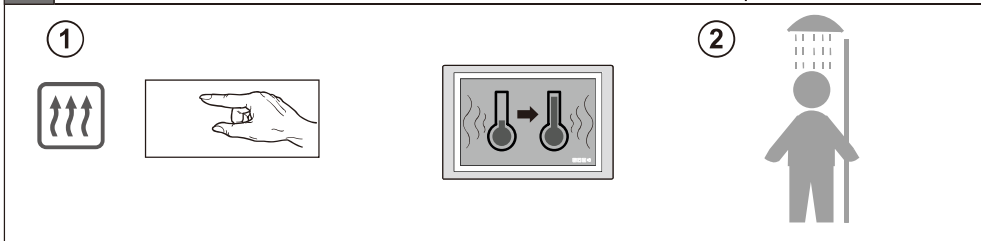

Soundsystem **Système audio** **Soundsystem**
Sound system **Sistema de sonido** **Акустическая система**

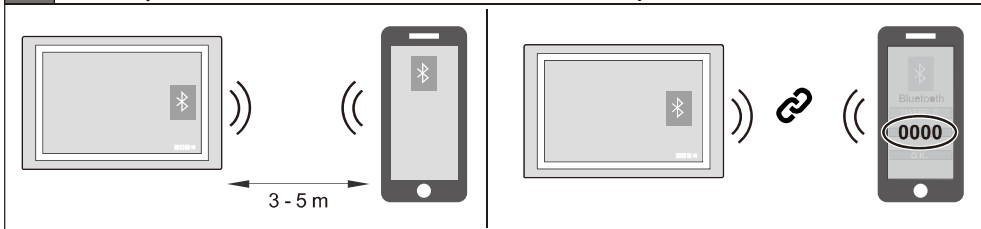

English

⚠ WARNING Read the instructions prior to installation and operation! Failure to follow the instructions can lead to electric shock, fires or injuries. Keep the instructions and pass them on to the user after installation.

Installation may only be carried out by trained electricians. A trained electrician is a person with adequate professional training, knowledge and experience to recognise hazards posed by electricity and avoid them.

This device is not intended for use by children younger than 8 and persons with restricted physical, sensory or mental capabilities or lack of experience and knowledge, unless they are supervised by a person who is responsible for safety or have been provided with instruction on how to use the device.

Children must be supervised in order to ensure that they do not play with the device.

The LED lights can become very hot. Do not place easily inflammable items on the mirror. Risk of fire.

The LED lights can become very hot. Do not touch the lights. Risk of burning.

Electrical safety
 Neglecting the following points poses the risk of electric shock:
 • Never open or modify the device.
 • Do not use the device with a damaged mains connection cable.

Correct purpose of use
 The device is intended for lighting indoors.

Incorrect purpose of use
 • The device is not intended for use with a dimmer switch.

Installation
 • The wall on which the mirror will be mounted must be suited for the weight of the mirror.
 • The device may only be mounted with the supplied mounting material.
 • Installation must be carried out by two persons.

Demister
 The demister automatically turns off after 45 min.

Cleaning and maintenance
 • After it is cooled down, clean the mirror surface with a moist cloth.
 • Dry off the mirror edges.
 • Do not use chemical cleaners or scouring agents.

The device does not contain any parts which the user can repair. In the event of a defect, replace the device.

Disturbance
 Removing the protective film from the mirror glass may result in electrostatic charging of the mirror surface. This may temporarily interfere with the function of the touch keys.

Disposal
 Do not dispose of the device in household waste.
 Please note the country-specific regulations.